

# K PUSH TECH

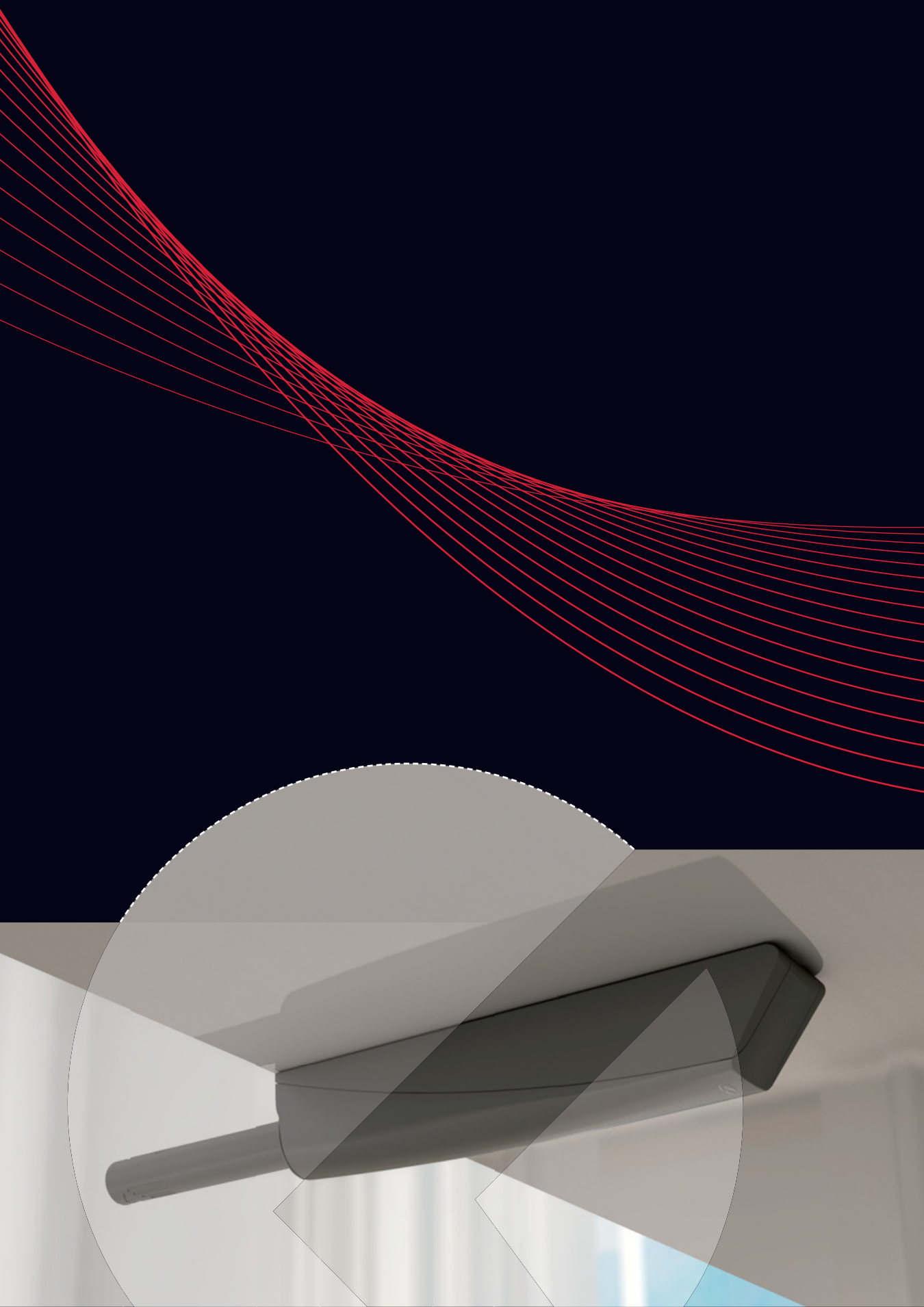

PUSH CATCHES  
AND MAGNETIC  
CATCHES





# SYMBOLS AND FINISHES LEGEND

## SYMBOLS

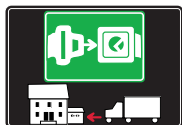

= SHELF SAFELY LOCKED DURING  
TRANSPORTATION AND AT HOME.



= ANTI-TURNOVER LOCKING  
SYSTEM



= NORMS / PATENTS



= PHILLIPS / POZIDRIV



= NEWTON



= PART.NO



= HEXAGONAL SOCKET



= FRICTION



= PCS. PER PACKAGE



= BLADE SLOT



= AUTOMATIC



= COMBI SLOT



= DROP DOWN



= CAPACITY LOADING



= COUNTERSUNK HEAD



= WOOD / GLASS THICKNESS



= PAN HEAD



= STANDARD HINGE



= HOLE DIAMETER



= FLANGE HEAD



= KIMANA HINGE



= DIAMETER



= FLAT HEAD



= FLAP HINGE



= LENGTH



= TRILOBULAR SCREW



= WITH SPRING



= HEIGHT



= SELF-TAPPING SCREW



= WITHOUT SPRING



= RIGHT VERSION



= EURO THREAD



= REVERSED SPRING



= LEFT VERSION



= METRIC THREAD



= FOR ROUND TUBE



= SETTING CODE



= PRE-INSERTED SCREW



= FOR OVAL TUBE



= PCS. PER PAD



= PRE-INSERTED SCREW  
AND SPREADING BUSH



= CUT ON REQUEST



= WITH BUFFER



= SELF ADHESIVE



= WITH MAGNET



= WITH FLANGE

NOTE: Printing errors and omissions may exist despite our best efforts to ensure accuracy. We reserve the right to alter specifications without notice.

## MATERIALS

<b>ZA</b> = Zinc Alloy	<b>ST</b> = Steel	<b>HSS</b> = High Speed Steel	<b>BR</b> = Brass	<b>ABS</b> = Acrylonitrile Butadiene Styrene
<b>ZAnk</b> = Nickel-plated Zinc Alloy	<b>STzk</b> = Zinc-plated Steel	<b>AL</b> = Aluminium	<b>WD</b> = Wood	<b>EVA</b> = Ethylene Vinyl Acetate

**EP** = **ENGINEERING PLASTIC**

+ **EP** = other engineering plastic available on request

**SR** = **SOFT RUBBER**

+ **SR** = other soft rubber available on request

**EPn** = Natural Engineering Plastic

**EPc** = Clear Engineering Plastic

**SRn** = Natural Soft Rubber

**EPw** = White Engineering Plastic

**EPg** = Grey Engineering Plastic

**SRw** = White Soft Rubber

**EPwg** = Water Green Engineering Plastic

**SRb** = Black Soft Rubber



## FINISHES



= OTHER FINISHES AVAILABLE ON REQUEST

PART. NO	FINISHES	PART. NO	FINISHES	PART. NO	FINISHES
AA	Natural	JB	Bright Aluminium	QB	Walnut
AB	White	JC	Aluminium - Chrome	RO	Red
AC	Opal White	JD	Matt Aluminium	UZ	T -Met
AE	White 9010	JE	Satin-finished Aluminium	WA	Bronzed
AK	Champagne	JF	Aluminium - Brass	WI	Burnished
AL	Ivory	JG	Aluminium 5	XD	Satin-finished Steel
EA	Black	JL	Aluminium PE 11	YA	Nickel-plated
EB	Glossy Black	JM	Aluminium RAL 9006	YB	Bright Nickel-plated
EC	Matt Black	KA	Chrome	YC	Matt Nickel-plated
EE	Anthracite	KB	Bright Chrome	YD	Satin-finished Nickel-plated
FU	Gunmetal	KC	Matt Chrome	ZA	Zinc alloy
GR	Raw	MA	Brown	ZN	Zinc-plated
HA	Brass-Plated	MB	Light Brown 1	ZQ	Bright Gold
HH	Tropicalized	NN	Metallic Beige	ZY	Titanium
HL	Raw Brass	NO	Beige	ZZ	Clear
IA	Grey	OA	Oak	00	Insignificant finish
IB	Metallic Grey	OZ	Ash		
IF	Middle Grey	PA	Light Ash		
IJ	Light Grey	PZ	Beech		
IL	Grey 20	QA	Maple		

## K PUSH TECH

 PATENT PENDING, REGISTERED DESIGN

**K PUSH TECH** is the fully renewed and extended program of automatic opening systems for doors without handles or knobs.

A special inner mechanism provides a very silent, yet powerful utilization, granting a long durability which makes it perfectly suitable for a wide range of doors.

**K PUSH TECH** is available with buffer, for cabinets using sprung hinges, and with magnet, for cabinets using unsprung hinges or negative hinges. The aesthetic of buffers is now improved and the range of catch plates for version with magnet is even wider.

It comes with a fresh new and even more captivating design, together with an extended program, including an innovated range of spring strengths, in order to guarantee the correct functioning even with large and heavy doors, and three lengths of the output paths: Short – 14,5 mm, Medium – 20 mm, Long – 37 mm.

The same reference can be installed either concealed or visible, fixed with adapter housing. The visible versions' package is composed of: push-to-open system, adapter plate and adapter housing. The new adapter housing allows to pre-install **K PUSH TECH** with the plate on the side of the cabinet and leave the ejector pin deactivated during its handling and transportation.

The suitability of the small adapter housing for both short and medium size versions guarantees a simplified stock management.

It comes with a wide range of colors: white, grey 19 and black anthracite.

Gap between door and cabinet is reduced: activation gap is 1,4 mm. Ring thickness is 0,6 mm.

Increased adjustment feature: +6 / -0,45 mm. Beyond this negative adjustment the spring is deactivated. This feature allows to disable the ejector pin for safety reasons.

Perception of steps indicating the adjustment of the ejector pin: every step-stop position adjusts the door gap by 0,15 mm. A click-stop indicates the maximum adjustment range. These features prevent any undesired change of position of the ejector pin during its utilization.

Reduced depth of drill hole (10 mm less) for the long concealed version.

Full-automatic mounting templates, bringing a significant advantage in productivity.

Possibility of installation in tight drill-holes

- Perfect functioning assured even with hole diameters with small tolerance.

New adapter housing

- The new adapter plates suit with current drilling pattern.
- The fixing of the adapter plate can be carried out with common self-tapping flat head screws and euro screws.
- The adapter plate can be used as template for the spot-drilling.

Highest magnet strength available in the market.

New high performing materials to withstand unusual stresses and to avoid parts' damages.

The new magnets are installed completely flush with the head of the ejector pin, in order to avoid any scratches on the door plates.

### INSTALLATION TO BE EMBEDDED INSIDE THE PANEL

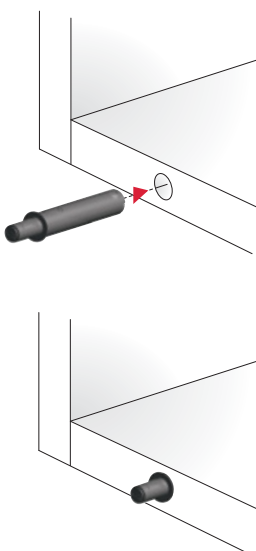

WITH MAGNET  
for cabinets using **unsprung hinges**  
or **negative hinges**.

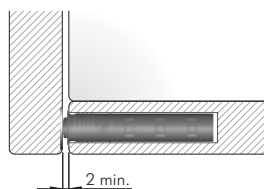

For details refer to  
"K PUSH TECH AND  
K LOCK DOOR PLATES".

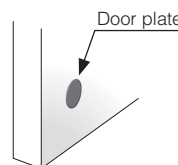

WITH BUFFER  
for cabinets using **sprung hinges**.

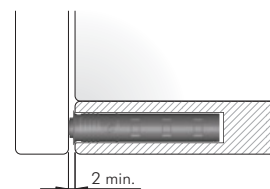

### VERSIONS

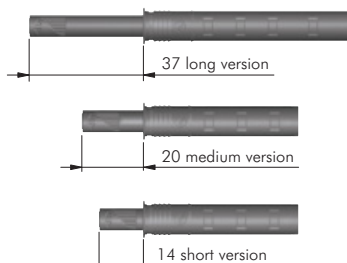

### ADJUSTMENTS

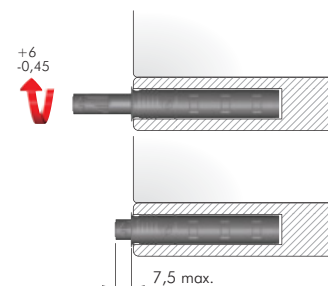

### INSTALLATION THROUGH ADAPTER HOUSING

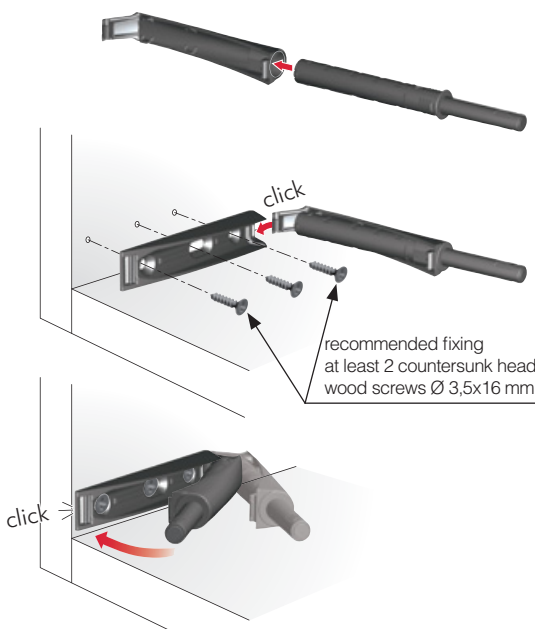

WITH MAGNET  
for cabinets using **unsprung hinges**  
or **negative hinges**.

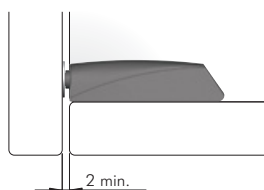

For details refer to  
"K PUSH TECH AND  
K LOCK DOOR PLATES".

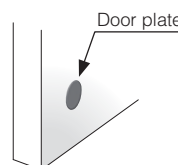

WITH BUFFER  
for cabinets using **sprung hinges**.

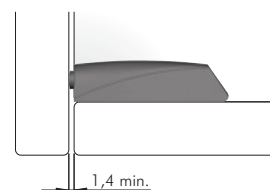

### VERSIONS

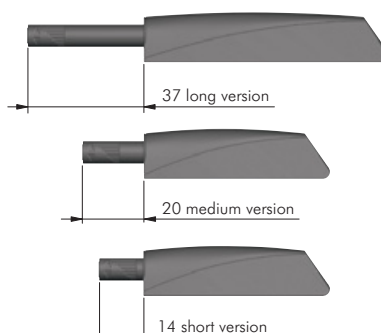

### ADJUSTMENTS

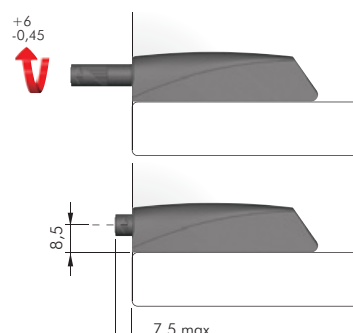

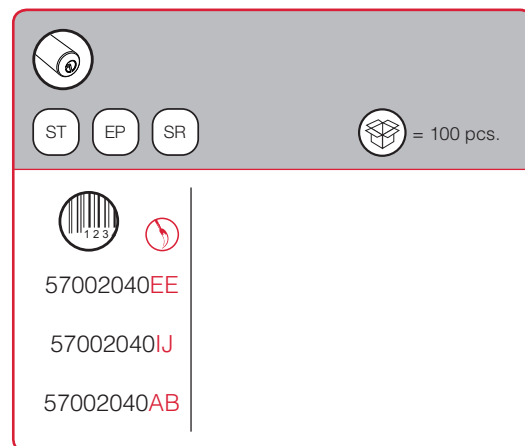
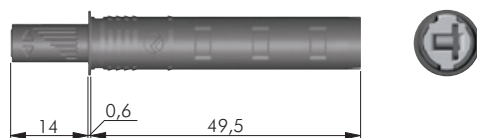
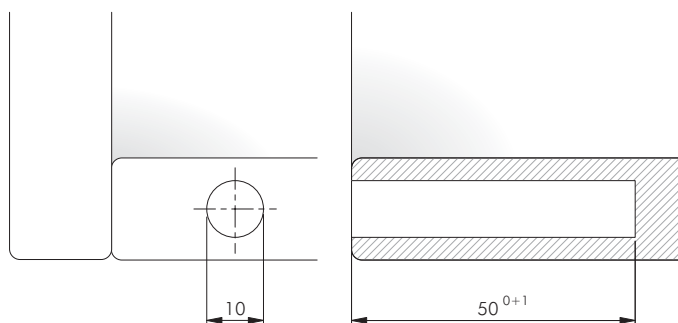
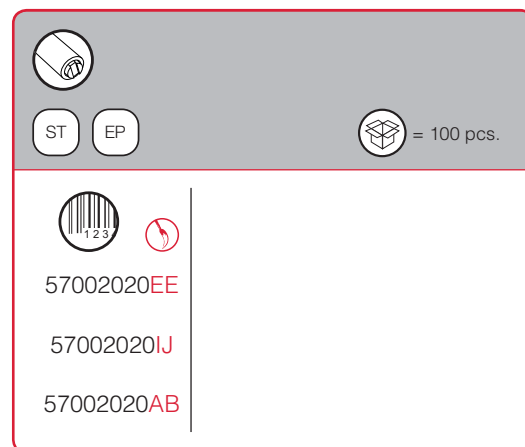
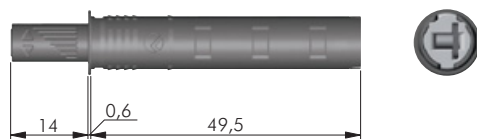
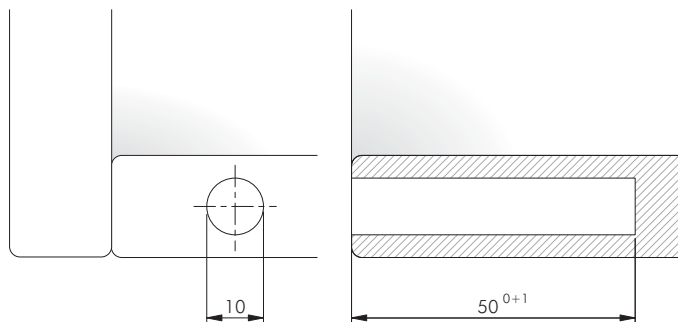





PUSH CATCHES  
AND MAGNETIC  
CATCHES

# K PUSH TECH

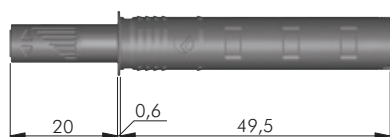
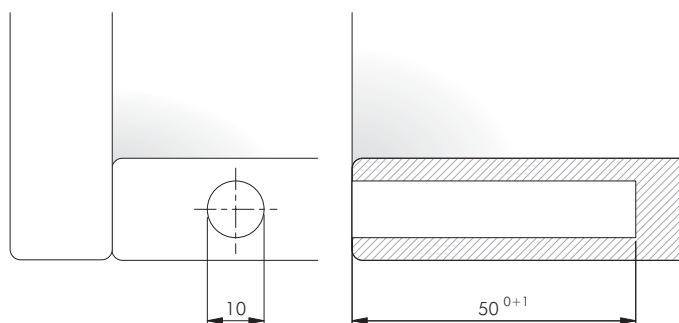

**ITALIANA**  
ferramenta





ST EP

 = 100 pcs.



57004020EE

57004020IJ

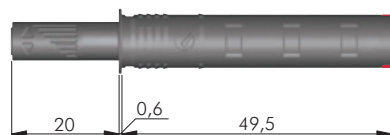
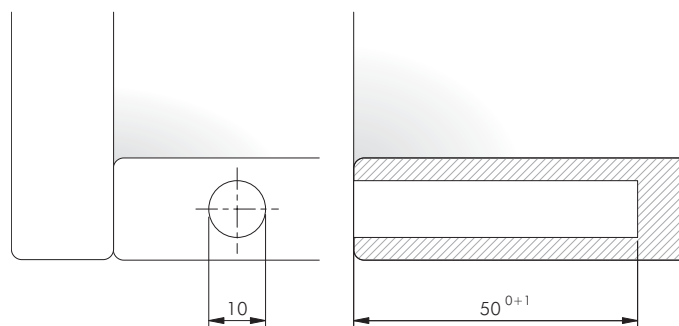

57004020AB



**STRONG VERSION**

ST EP

 = 100 pcs.



57004060EE

57004060IJ

57004060AB

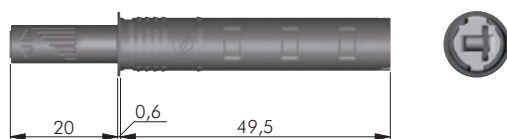
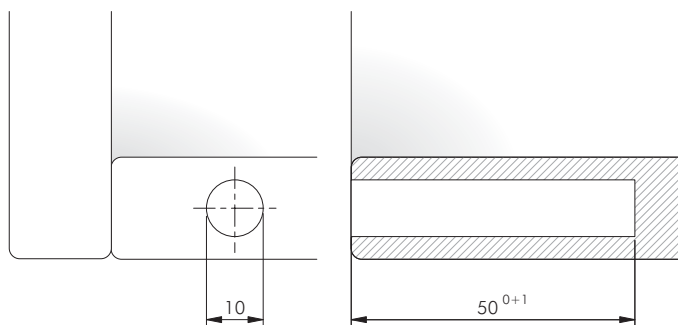

ST

EP

SR

= 100 pcs.

57004040EE  
57004040IJ  
57004040AB

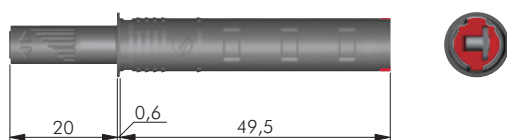
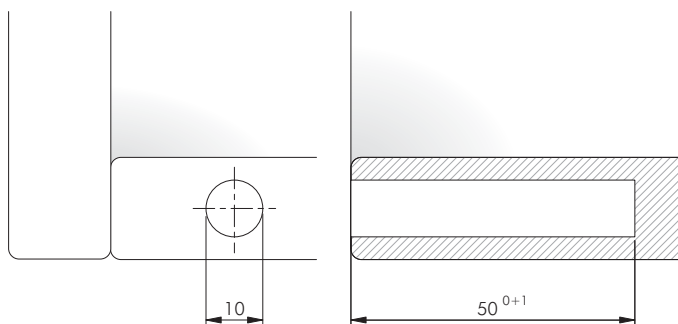

ST

EP

SR

= 100 pcs.

57004080EE  
57004080IJ  
57004080AB

## ADAPTER HOUSING AND PLATE FOR **SHORT** AND **MEDIUM** VERSIONS

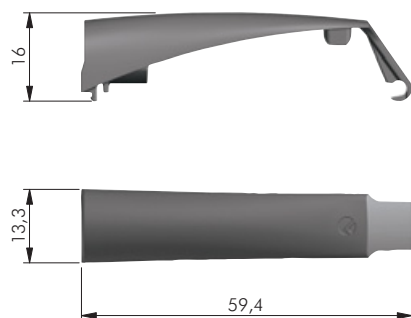

EP

= 100 pcs.



57006020**EE**

57006020**IJ**

57006020**AB**

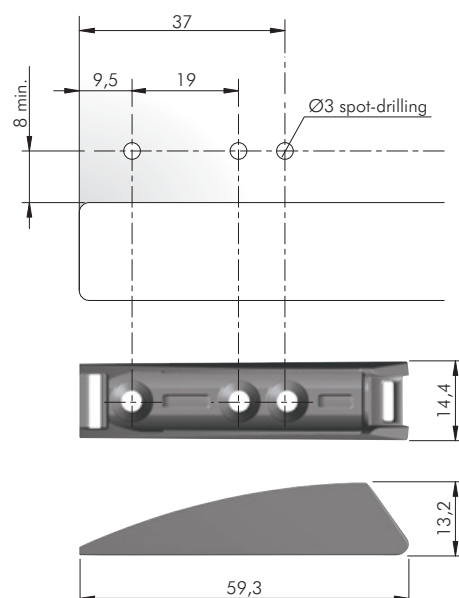

= Ø 2,5 mm

EP

= 100 pcs.



57006040**EE**

57006040**IJ**

57006040**AB**

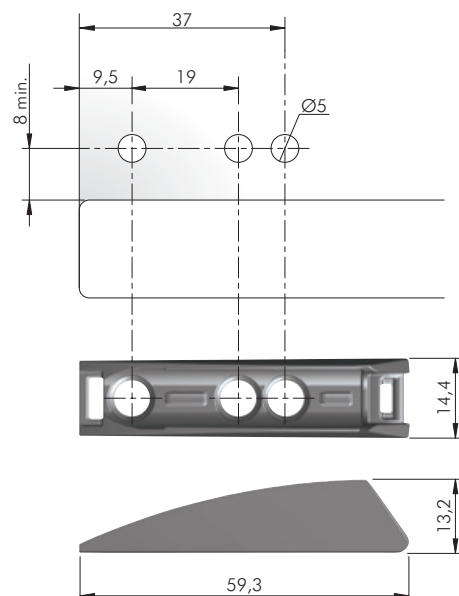

= Ø 5 mm

EP

= 100 pcs.



57006060**EE**

57006060**IJ**

57006060**AB**



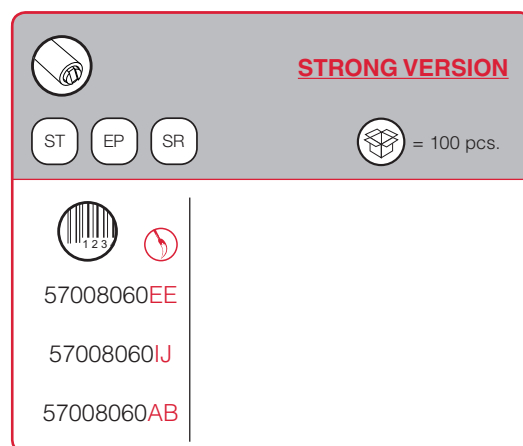
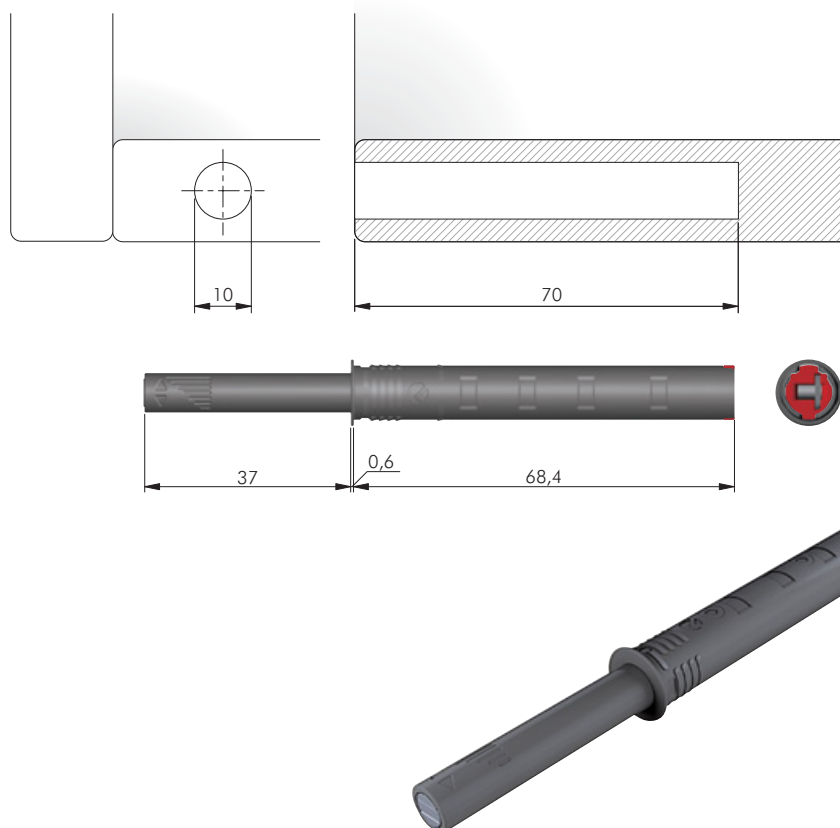
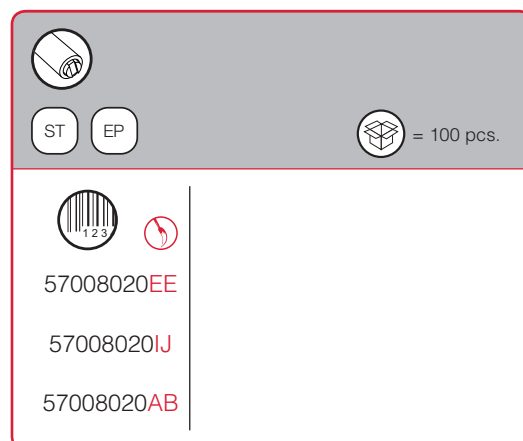
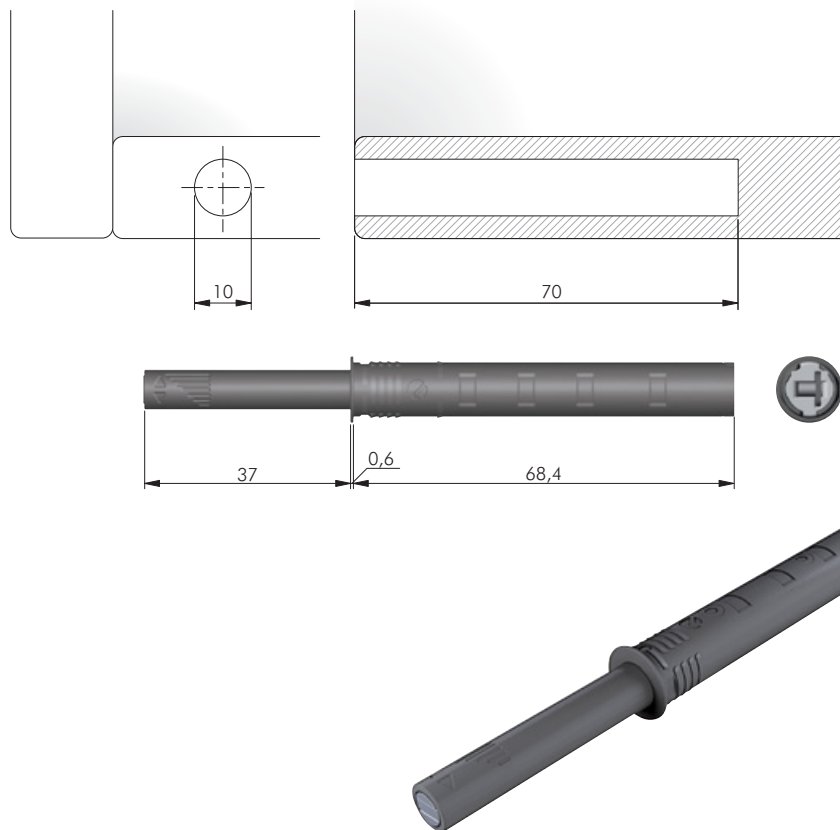









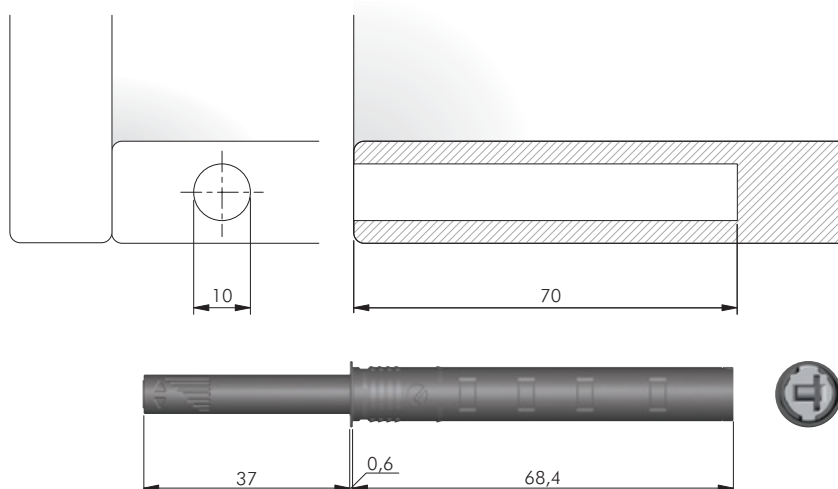

PUSH CATCHES  
AND MAGNETIC  
CATCHES

# K PUSH TECH





**ITALIANA**  
ferramenta



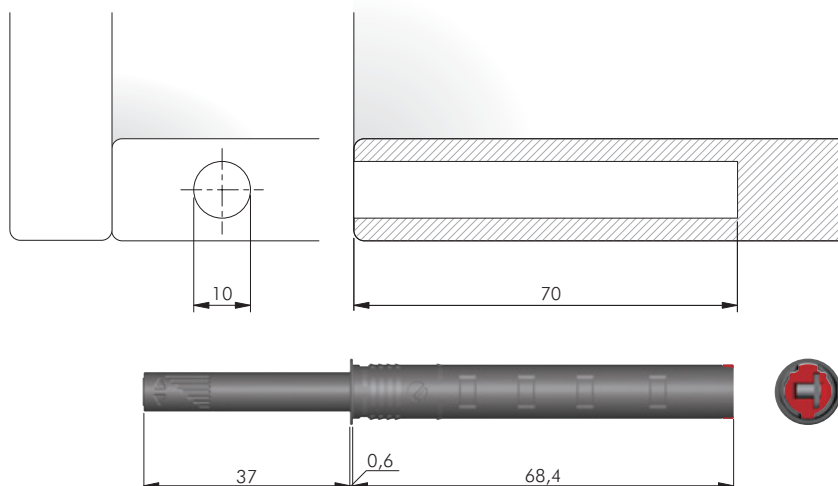

 = 100 pcs.

  
57008040EE  
57008040IJ  
57008040AB



**STRONG VERSION** = 100 pcs.

  
57008080EE  
57008080IJ  
57008080AB



## ADAPTER HOUSING AND PLATE FOR **LONG** VERSION

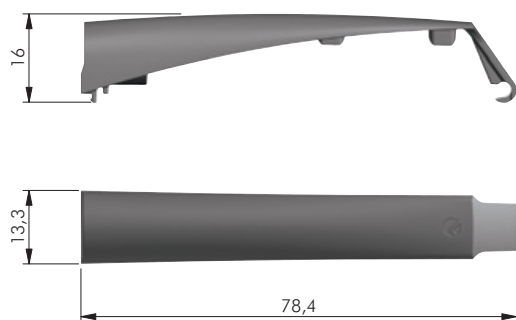

EP

= 100 pcs.



57010020**EE**

57010020**IJ**

57010020**AB**

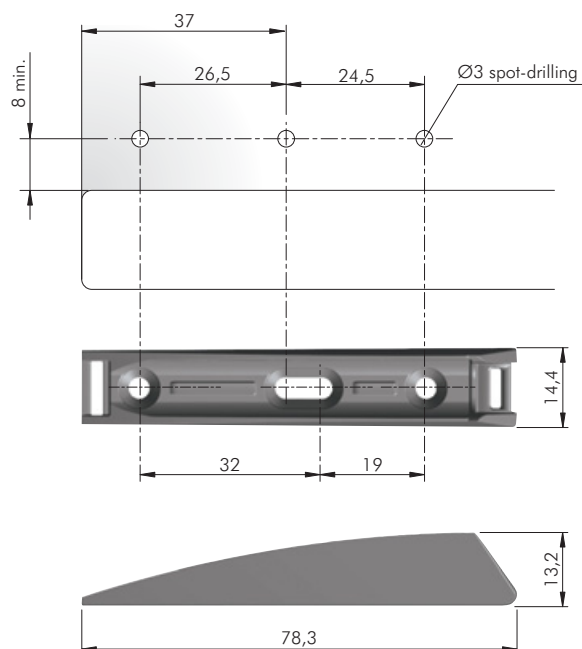

EP



= Ø 2,5 mm

= 100 pcs.



57010040**EE**

57010040**IJ**

57010040**AB**

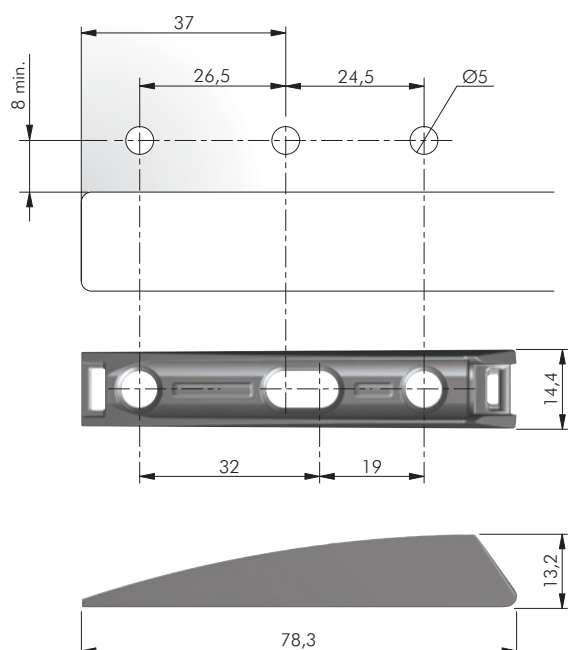

EP



= Ø 5 mm

= 100 pcs.



57010060**EE**

57010060**IJ**

57010060**AB**

## FIXING ACCESSORY FOR K PUSH TECH ADAPTER PLATES PART. NO 57006040, 57010040

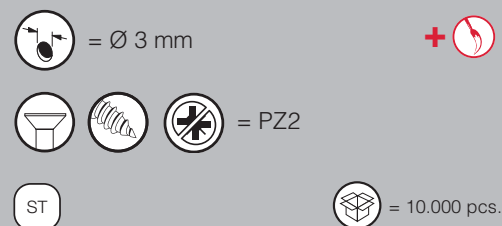
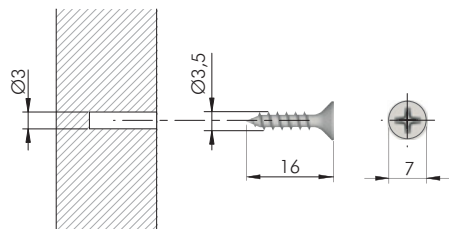

## FIXING ACCESSORY FOR K PUSH TECH ADAPTER PLATES PART. NO 57006060, 57010060, 57010080

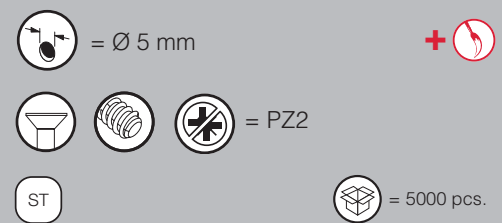
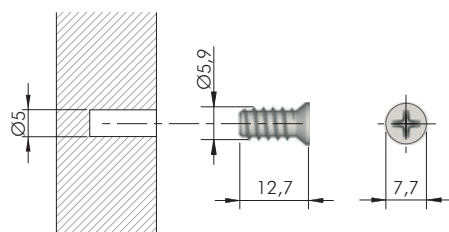

## K PUSH TECH INSTALLING TOOL

### APPLICATION

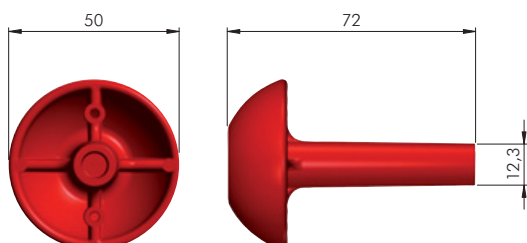
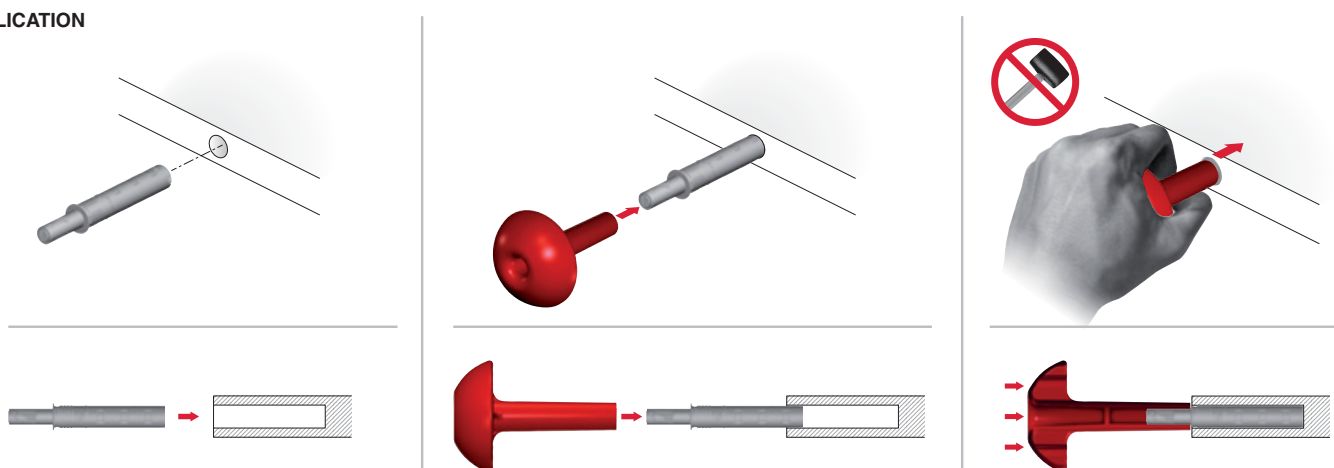



## K PUSH TECH AND K LOCK DOOR PLATES

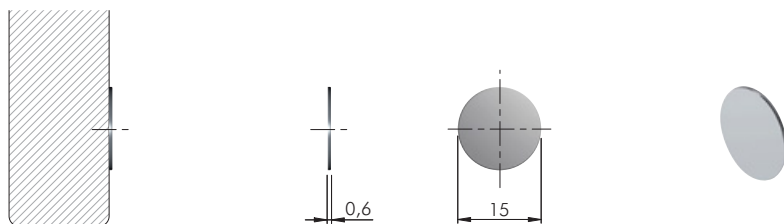

ST

= 100 pcs.



55006020XD

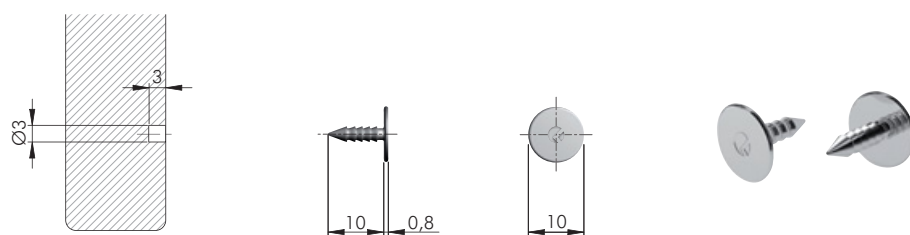

= Ø 3 mm

ST

= 100 pcs.



55006030YA

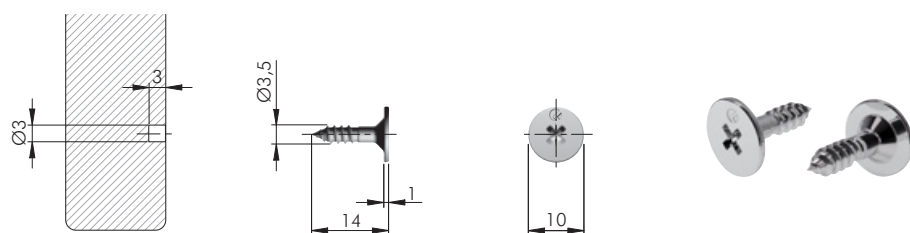

= Ø 3 mm



= PZ2

ST

= 100 pcs.



55006100YA

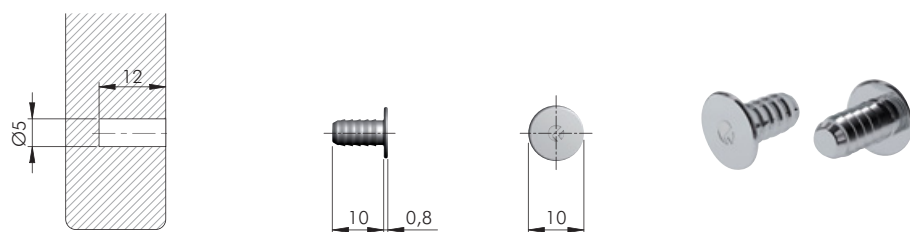

= Ø 5 mm

ST

= 100 pcs.



55006040YA

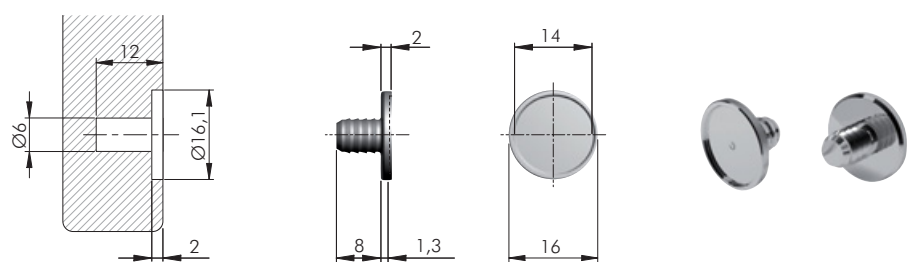

= Ø 6 mm

ST

= 100 pcs.



55006070YA

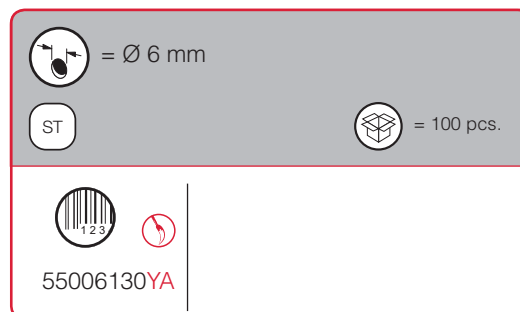
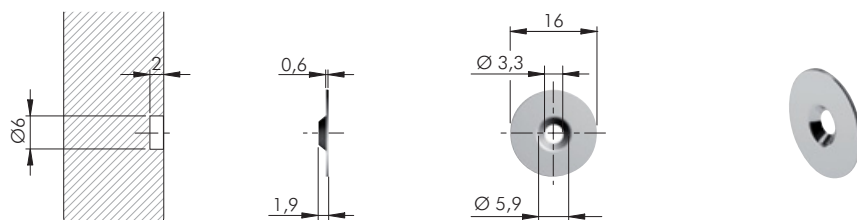
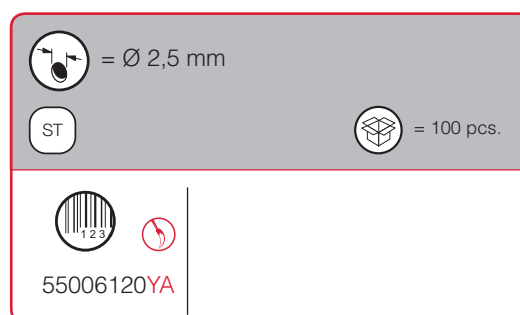
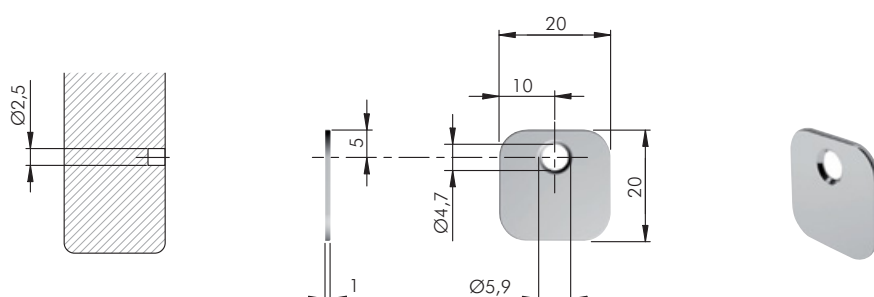
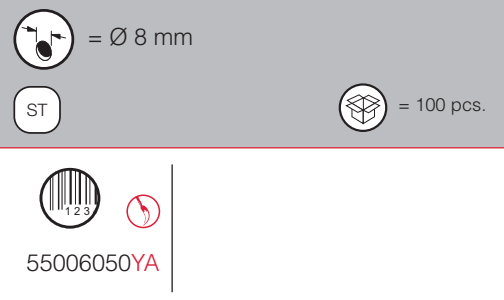
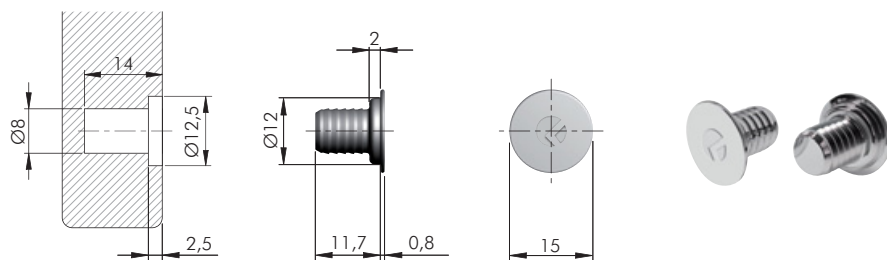

## ACCESSORY FOR PART.NO 55006130YA AND 55006120YA

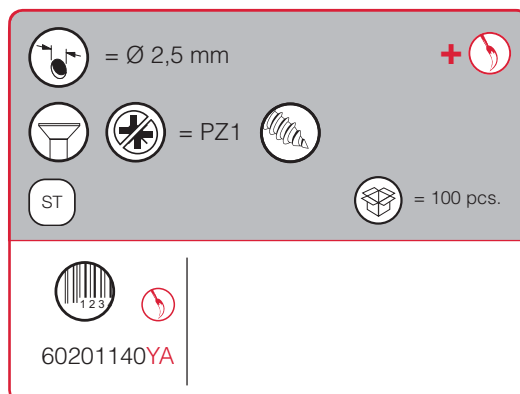
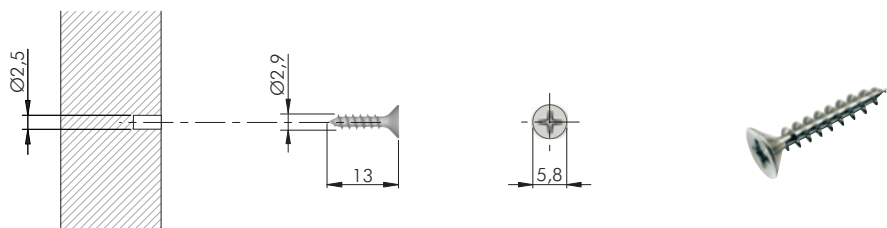



## PLATE FOR K PUSH WITH ADAPTER HOUSING FOR CURVED DOORS

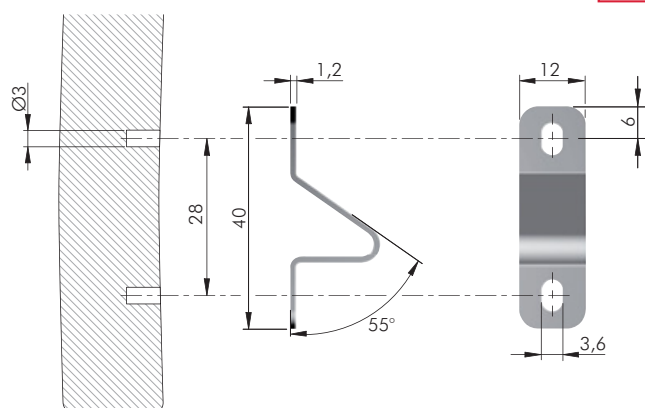
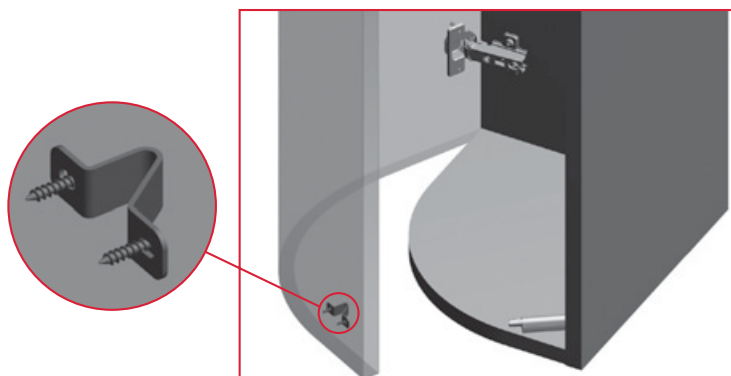

= Ø 3 mm

ST



= 100 pcs.



55006110YA

## ACCESSORY FOR PART.NO 55006110YA

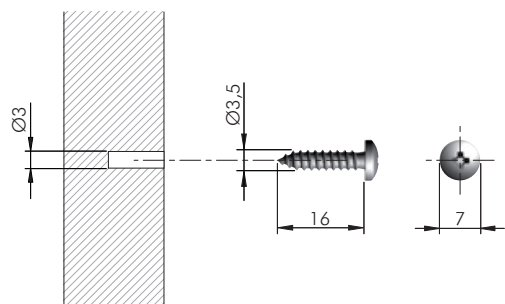

= Ø 3 mm



= PZ1



ST



= 100 pcs.



60103140YA

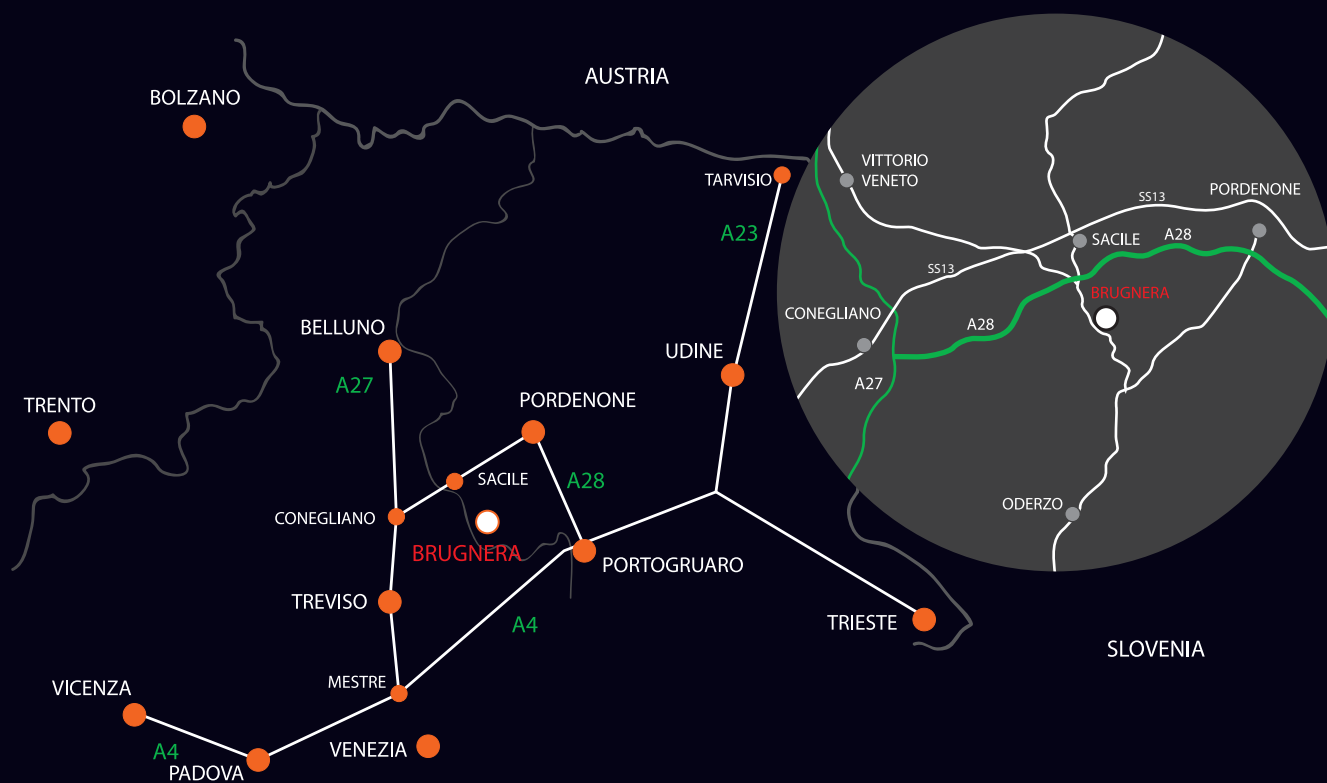

[www.italianaferramenta.com](http://www.italianaferramenta.com)