

KIMANA

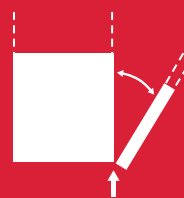

HINGES

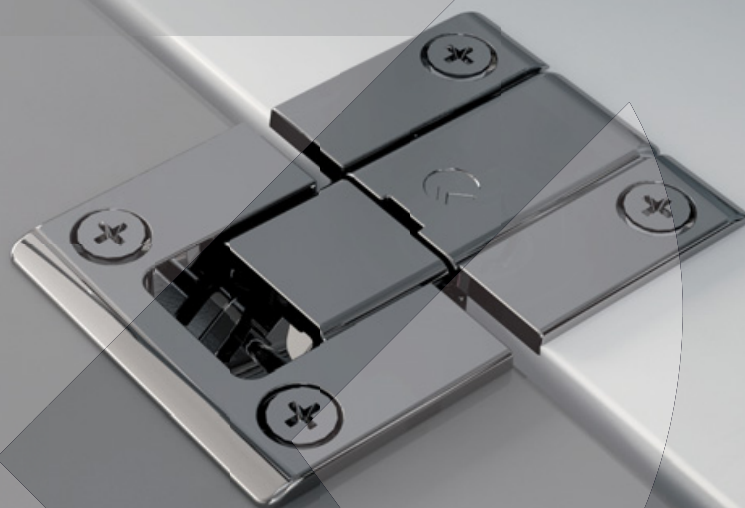



SYMBOLS AND FINISHES LEGEND

SYMBOLS

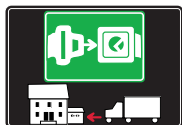

= SHELF SAFELY LOCKED DURING
TRANSPORTATION AND AT HOME.



= ANTI-TURNOVER LOCKING
SYSTEM



= NORMS / PATENTS



= PHILLIPS / POZIDRIV



= NEWTON



= PART.NO



= HEXAGONAL SOCKET



= FRICTION



= PCS. PER PACKAGE



= BLADE SLOT



= AUTOMATIC



= COMBI SLOT



= DROP DOWN



= CAPACITY LOADING



= COUNTERSUNK HEAD



= WOOD / GLASS THICKNESS



= PAN HEAD



= STANDARD HINGE



= HOLE DIAMETER



= FLANGE HEAD



= KIMANA HINGE



= DIAMETER



= FLAT HEAD



= FLAP HINGE



= LENGTH



= TRILOBULAR SCREW



= WITH SPRING



= HEIGHT



= SELF-TAPPING SCREW



= WITHOUT SPRING



= RIGHT VERSION



= EURO THREAD



= REVERSED SPRING



= LEFT VERSION



= METRIC THREAD



= SETTING CODE



= PRE-INSERTED SCREW



= FOR ROUND TUBE



= PCS. PER PAD



= PRE-INSERTED SCREW
AND SPREADING BUSH



= FOR OVAL TUBE



= CUT ON REQUEST



= WITH BUFFER



= SELF ADHESIVE



= WITH MAGNET



= WITH FLANGE

NOTE: Printing errors and omissions may exist despite our best efforts to ensure accuracy. We reserve the right to alter specifications without notice.

MATERIALS

ZA = Zinc Alloy	ST = Steel	HSS = High Speed Steel	BR = Brass	ABS = Acrylonitrile Butadiene Styrene
ZAnk = Nickel-plated Zinc Alloy	STzk = Zinc-plated Steel	AL = Aluminium	WD = Wood	EVA = Ethylene Vinyl Acetate

EP = **ENGINEERING PLASTIC**

+ **EP** = other engineering plastic available on request

SR = **SOFT RUBBER**

+ **SR** = other soft rubber available on request

EPn = Natural Engineering Plastic

EPc = Clear Engineering Plastic

SRn = Natural Soft Rubber

EPw = White Engineering Plastic

EPg = Grey Engineering Plastic

SRw = White Soft Rubber

EPwg = Water Green Engineering Plastic

SRb = Black Soft Rubber



FINISHES



= OTHER FINISHES AVAILABLE ON REQUEST

PART. NO	FINISHES	PART. NO	FINISHES	PART. NO	FINISHES
AA	Natural	JB	Bright Aluminium	QB	Walnut
AB	White	JC	Aluminium - Chrome	RO	Red
AC	Opal White	JD	Matt Aluminium	UZ	T -Met
AE	White 9010	JE	Satin-finished Aluminium	WA	Bronzed
AK	Champagne	JF	Aluminium - Brass	WI	Burnished
AL	Ivory	JG	Aluminium 5	XD	Satin-finished Steel
EA	Black	JL	Aluminium PE 11	YA	Nickel-plated
EB	Glossy Black	JM	Aluminium RAL 9006	YB	Bright Nickel-plated
EC	Matt Black	KA	Chrome	YC	Matt Nickel-plated
EE	Anthracite	KB	Bright Chrome	YD	Satin-finished Nickel-plated
FU	Gunmetal	KC	Matt Chrome	ZA	Zinc alloy
GR	Raw	MA	Brown	ZN	Zinc-plated
HA	Brass-Plated	MB	Light Brown 1	ZQ	Bright Gold
HH	Tropicalized	NN	Metallic Beige	ZY	Titanium
HL	Raw Brass	NO	Beige	ZZ	Clear
IA	Grey	OA	Oak	00	Insignificant finish
IB	Metallic Grey	OZ	Ash		
IF	Middle Grey	PA	Light Ash		
IJ	Light Grey	PZ	Beech		
IL	Grey 20	QA	Maple		



KIMANA

KIMANA is the new hinge conceived by Italiana Ferramenta to open and close flap and drop-down doors. Provided with a unique and exclusive movement, it allows to open cabinet doors in column, even when the cabinet bottom lies upon another panel or the cabinet top is surmounted by a decorative/lighting panel. The small dimensions (\varnothing 26mm boring for both the door and the bottom), the minimalistic and elegant design contribute to make **KIMANA** not only a functional hinge, but also a product unique in its genre. The fixing screws are perpendicular, thus making **KIMANA** suitable for perfect positioning, as well as for aluminium profiles. **KIMANA** can be easily adjusted through the screws (PZ2) which are hidden underneath the cover.

Various door and cabinet thickness-combinations can be solutioned either by carrying out the adjustments of the **KIMANA** or by plaing adapters under the hinge clip so that the ideal movement and alignment of the door are guaranteed.



GOOD DESIGN AWARD, 2012

PAT. PENDING
REGISTERED DESIGN

PAT. PENDING
REGISTERED DESIGN



INSTALLATION ON UNIT WITH SOLID DOOR (Application shown for minimum thickness 18 mm)

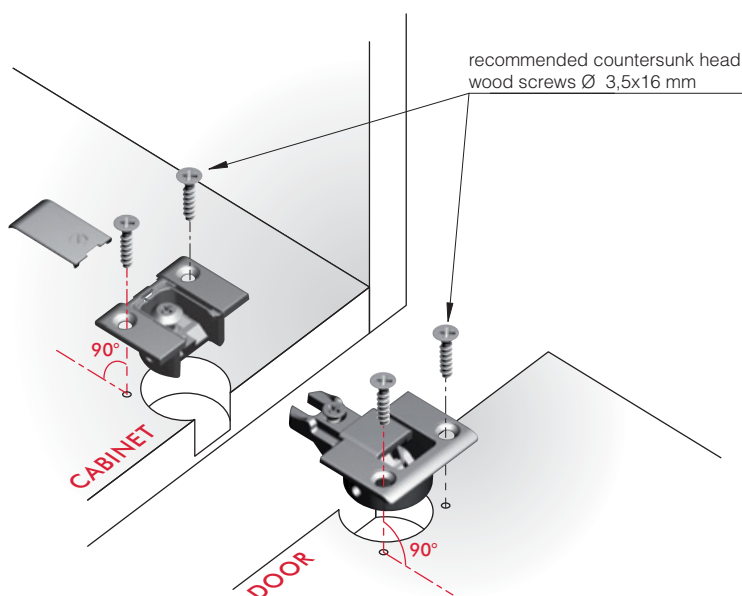

INSTALLATION ON UNIT WITH ALUMINIUM DOOR (Application shown for minimum thickness 18 mm)

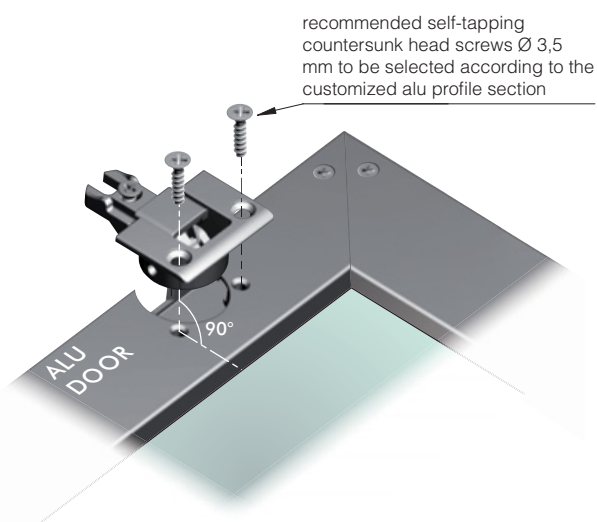

CASES WHERE TO USE KIMANA

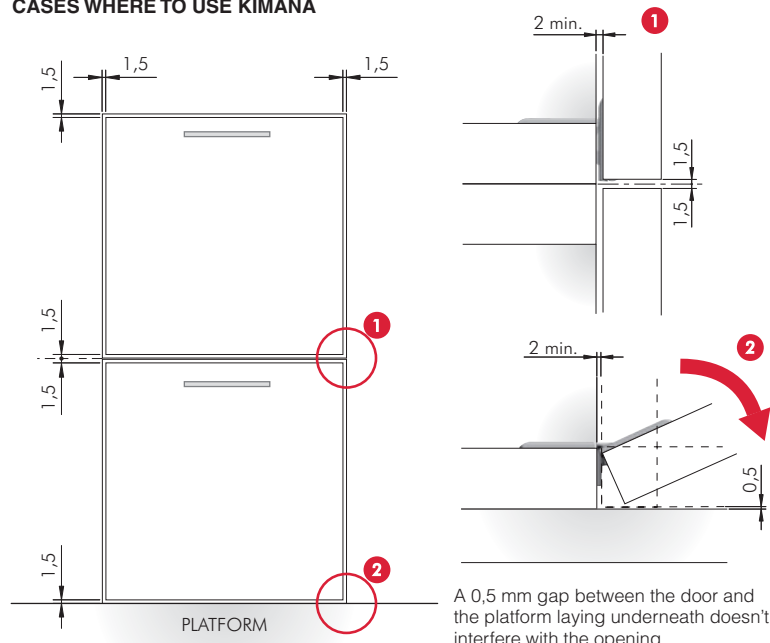

RECOMMENDED NUMBER OF KIMANA PER DOOR

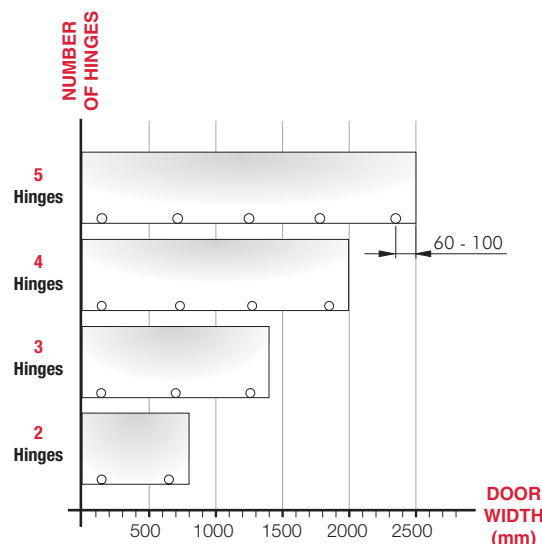

Due to various factors, the quantities stated in the chart are indicative.



DOOR INSTALLATION

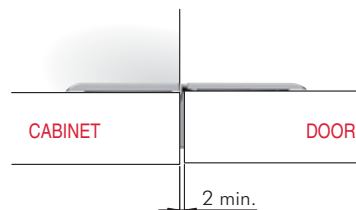
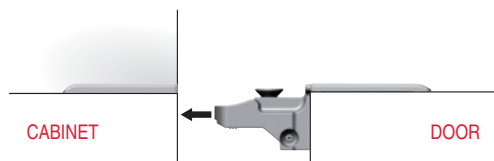

IN-DEPTH ADJUSTMENT 0+2 mm

⚠ TO BE MADE BEFORE
LOCKING SCREW OPERATION ⚠

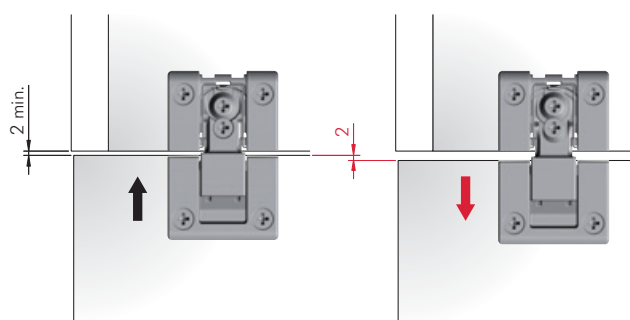

LATERAL ADJUSTMENT 0±1 mm

⚠ TO BE MADE BEFORE
LOCKING SCREW OPERATION ⚠

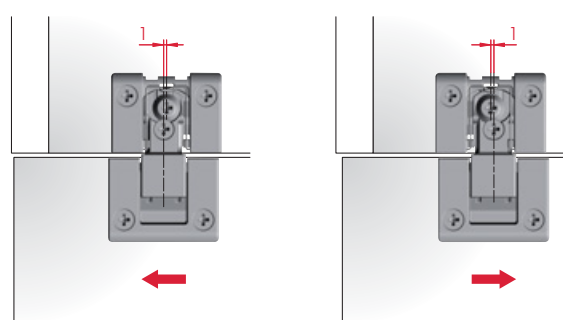

VERTICAL ADJUSTMENT 0+2 mm - DOOR OPEN

⚠ TO BE MADE BEFORE
LOCKING SCREW OPERATION ⚠

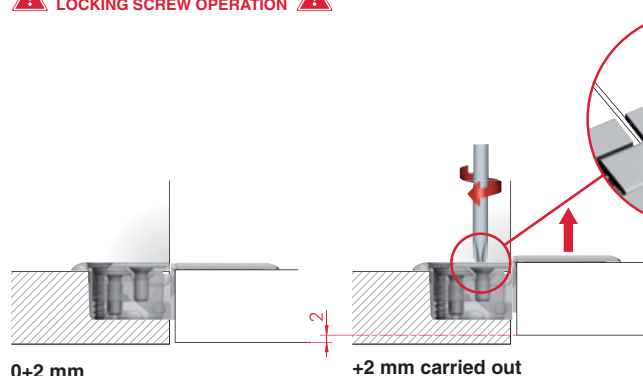

0+2 mm
Standard position

VERTICAL ADJUSTMENT 0+2 mm - DOOR CLOSED

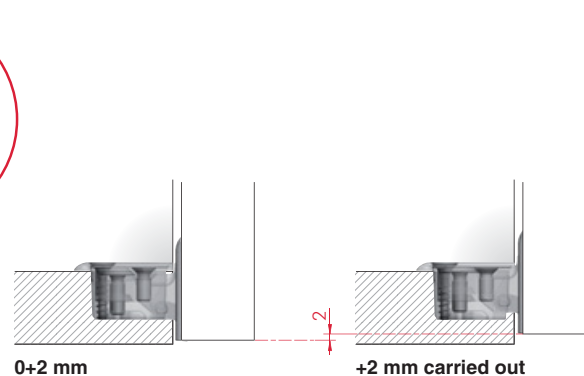

0+2 mm
Standard position

LOCKING SCREW

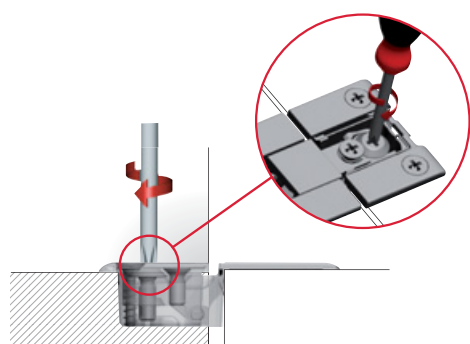

COVER CAP INSERTION

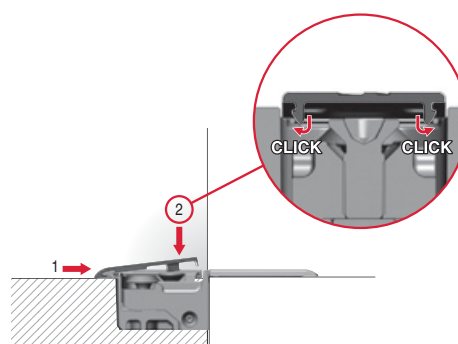

COVER CAP REMOVAL

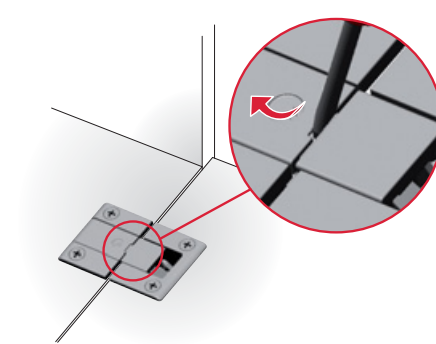

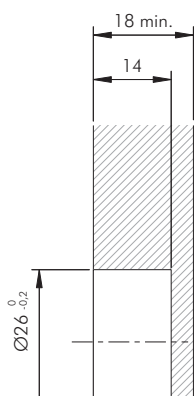

NOTE: For panel thickness lower than 18 mm, refer to "KIMANA ADAPTERS".

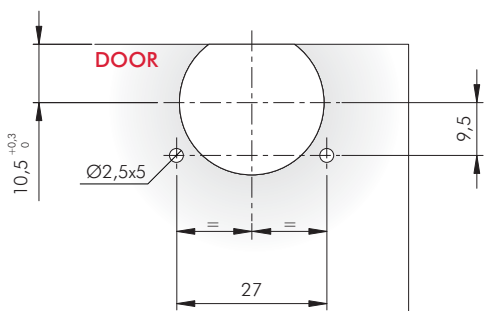
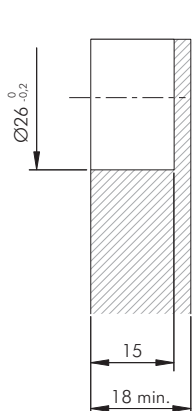
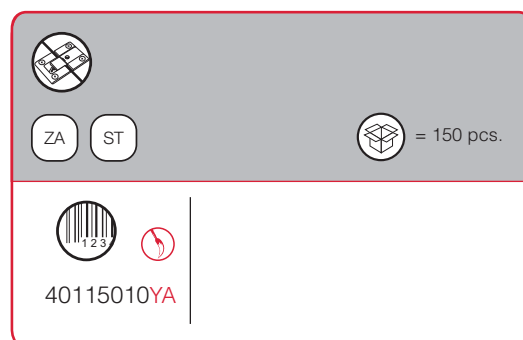
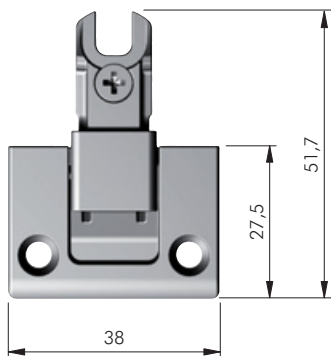
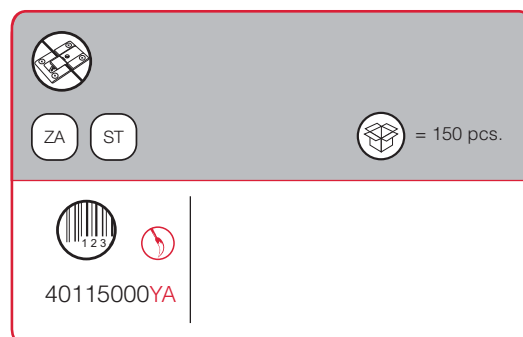
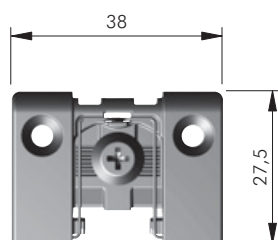
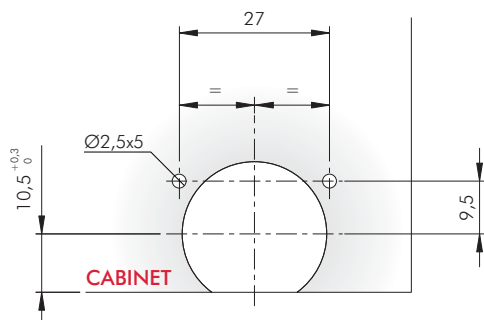

NOTE: For panel thickness lower than 18 mm, refer to "KIMANA ADAPTERS".

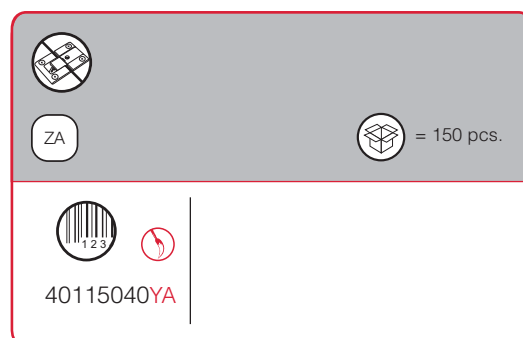
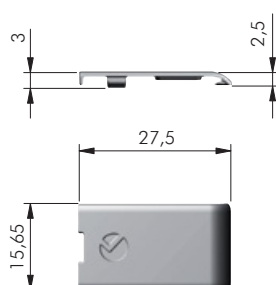

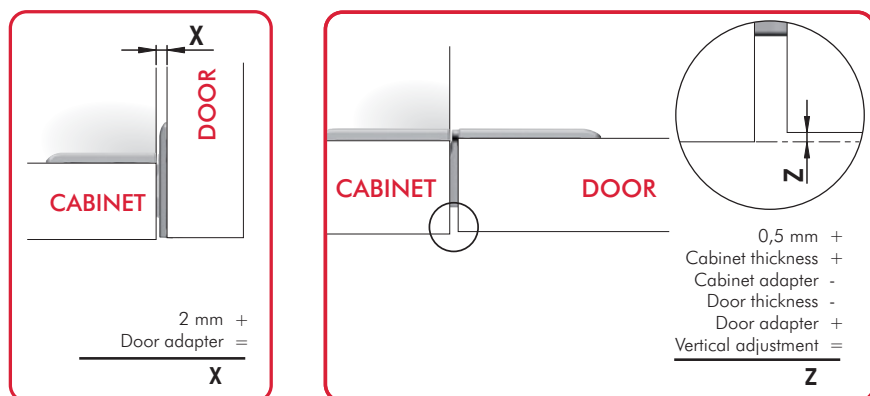

STANDARD DRILLING PLAN

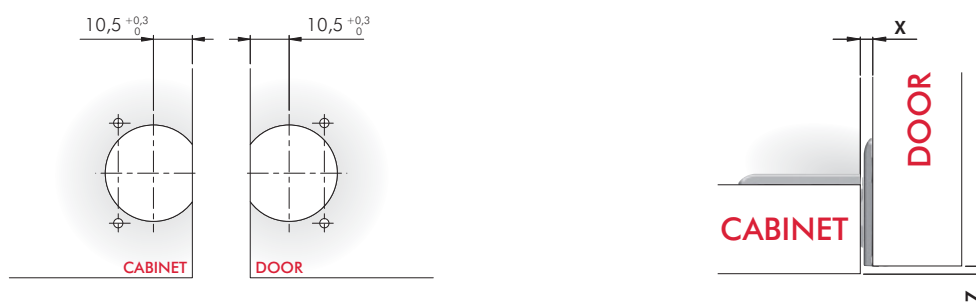

ALTERNATIVE DRILLING PLANS

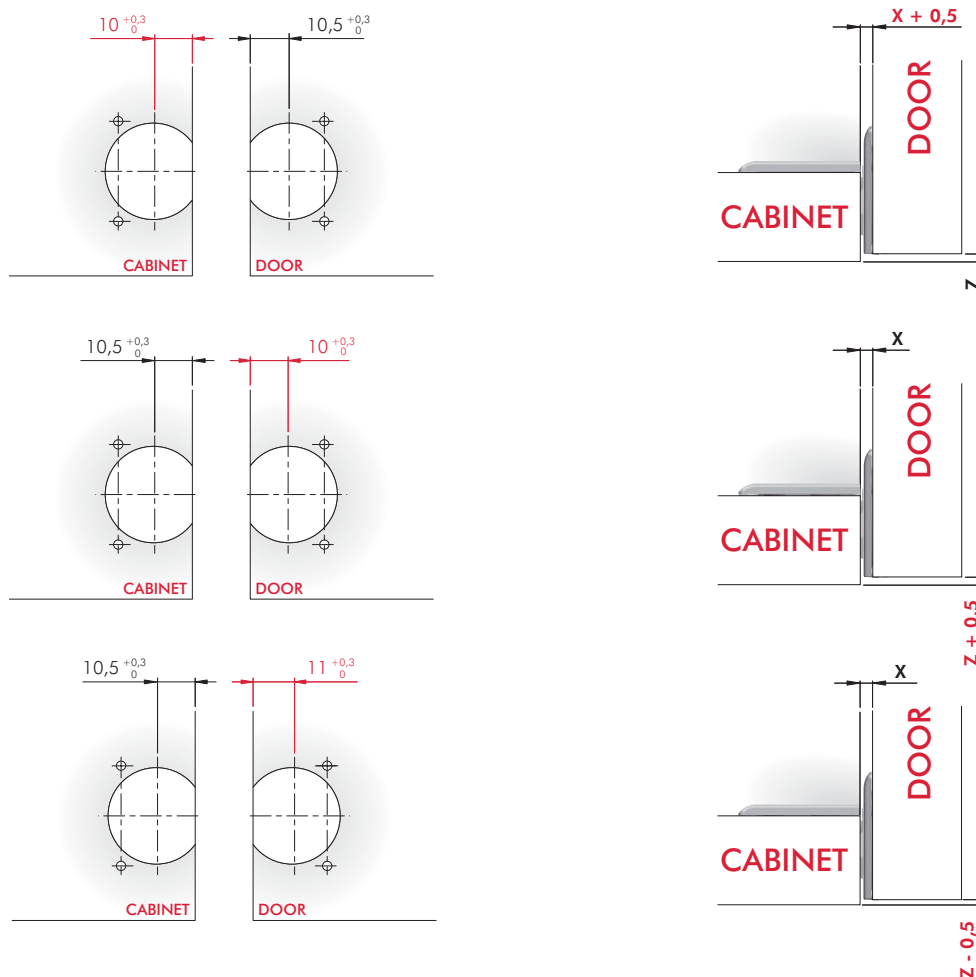



KIMANA ADAPTERS

INSTALLATION WITH ADAPTER

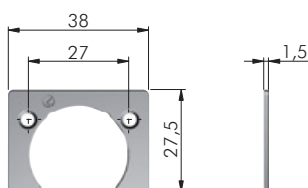
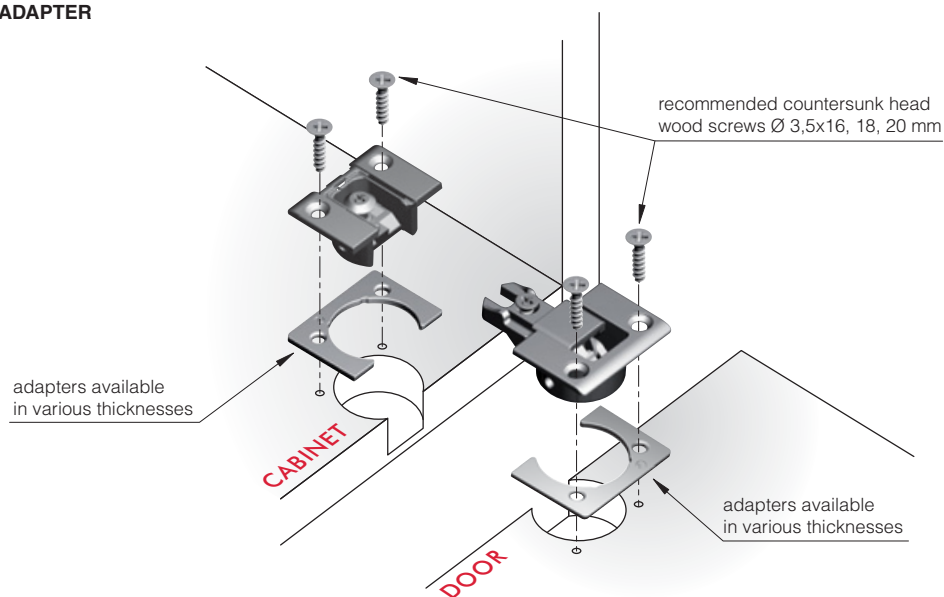

ZA

 = on request

40115320YA

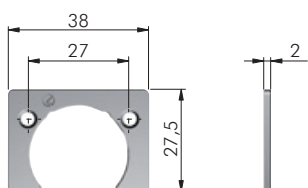

ZA

 = on request

40115340YA

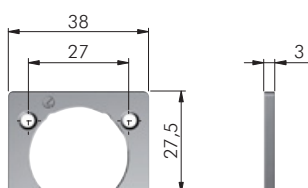

ZA

 = on request

40115360YA

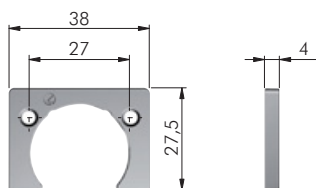

ZA	= on request
123	
40115400YA	

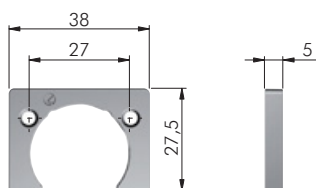

ZA	= on request
123	
40115440YA	

FIXING ACCESSORY FOR BOTH KIMANA AND ADAPTERS PART NO. 40115320YA - 40115340YA

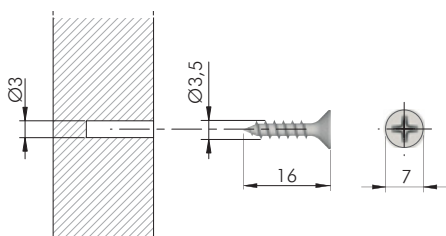

= Ø 3 mm	
= PZ2	
ST	= 10.000 pcs.
123	
60101390YA	

FIXING ACCESSORY FOR KIMANA ADAPTERS PART NO. 40115360YA - 40115400YA

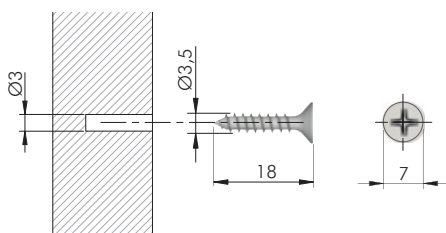

= Ø 3 mm	
= PZ2	
ST	= 10.000 pcs.
123	
60101400YA	









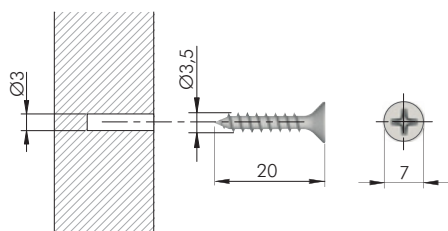

HINGES

KIMANA

ITALIANA[®]
ferramenta

FIXING ACCESSORY FOR KIMANA ADAPTER PART NO. 40115440YA



 = Ø 3 mm	
   = PZ2	
ST	 = 10.000 pcs.
 123	
60101410YA	

DOOR ALIGNMENT SPACER FOR KIMANA HINGES

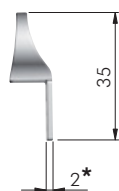
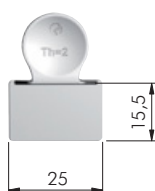
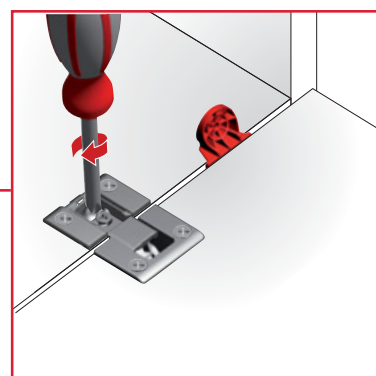
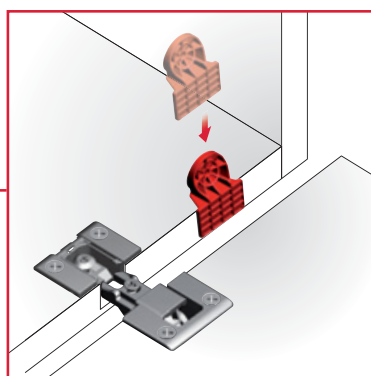
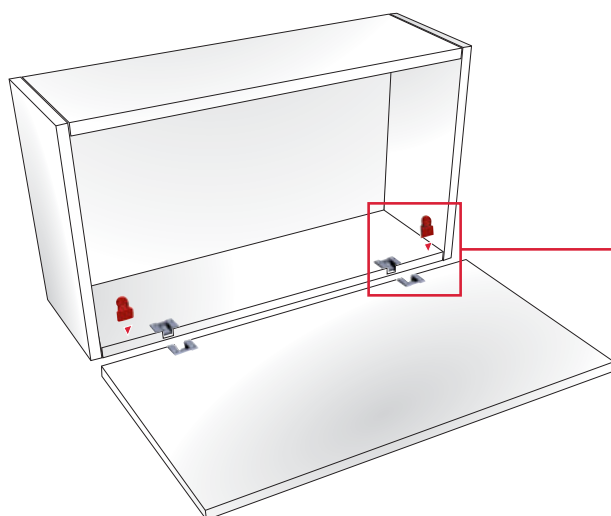

EP	 = on request
 123	
40115630RO	

2 pcs featured in each polybag.

* For non-standard drilling plans 1,5, 2,5, 3 and 4 mm spacers are also available.

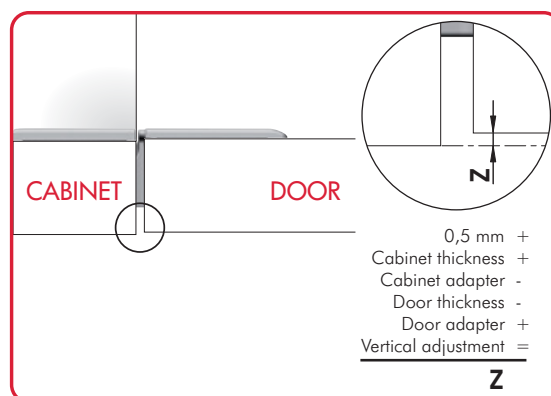
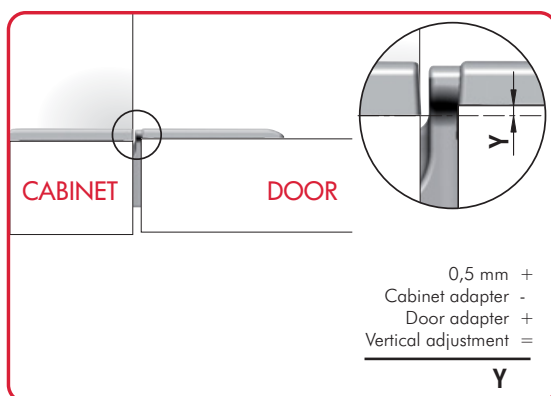
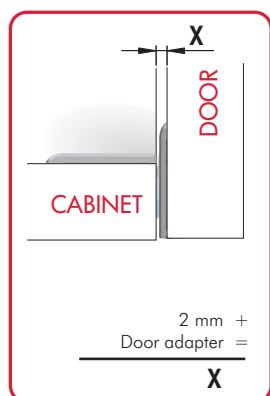

CABINET 16 mm WITH ADAPTER 4 mm THICK - DOOR 16 mm WITH ADAPTER 2 mm THICK

0 + 2 mm FURTHER VERTICAL ADJUSTMENT

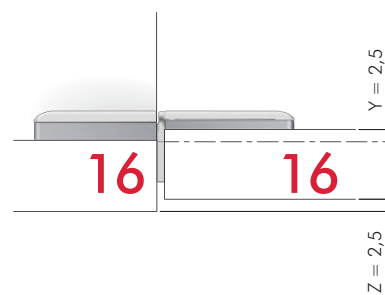
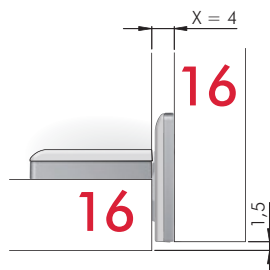
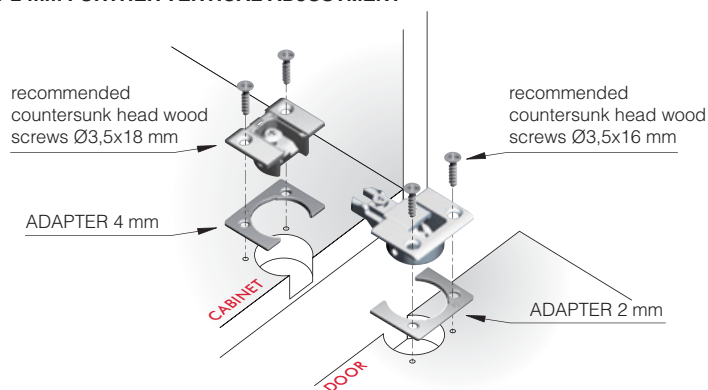

CABINET 16 mm WITH ADAPTER 4 mm THICK - DOOR 19 mm WITHOUT ADAPTER

0 + 2 mm FURTHER VERTICAL ADJUSTMENT

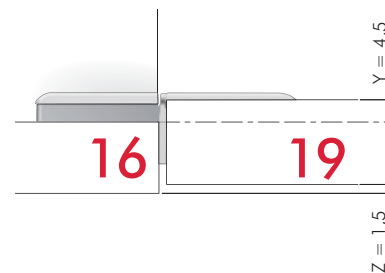
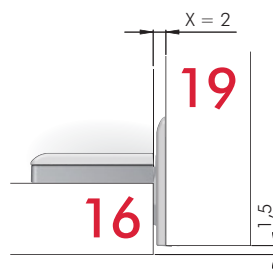
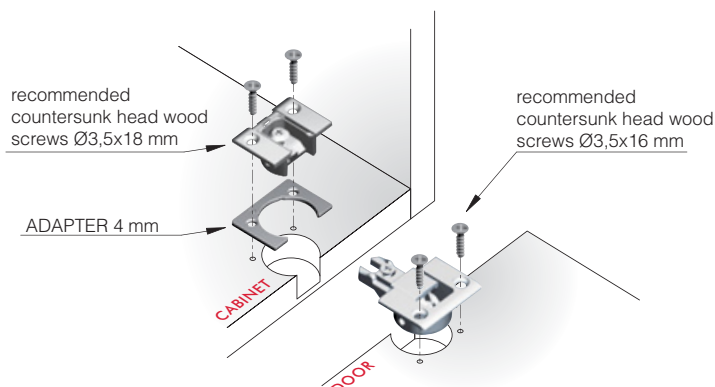

CABINET 16 mm WITH ADAPTER 4 mm THICK - DOOR 20 mm WITHOUT ADAPTER

0 + 2 mm FURTHER VERTICAL ADJUSTMENT

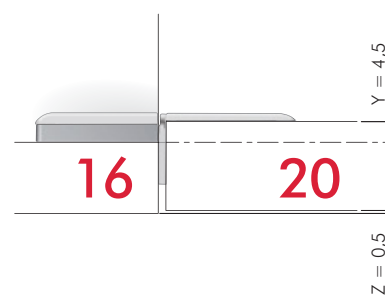
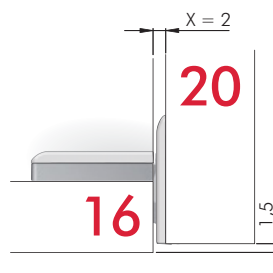
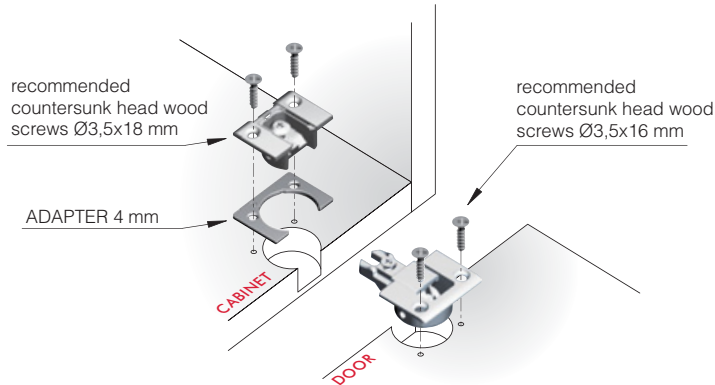

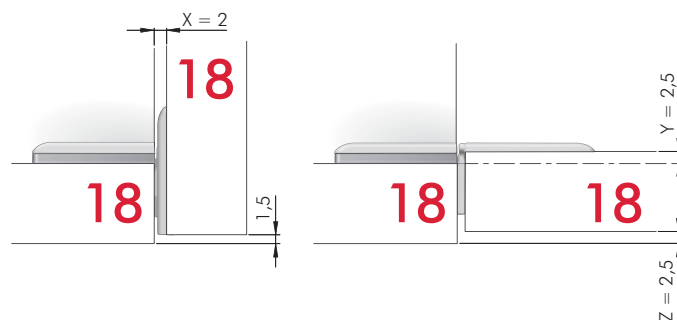
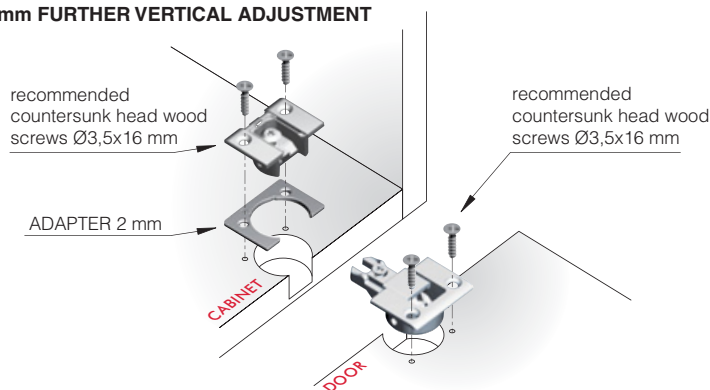
CABINET 18 mm WITH ADAPTER 2 mm THICK - DOOR 18 mm WITHOUT ADAPTER
0 + 2 mm FURTHER VERTICAL ADJUSTMENT

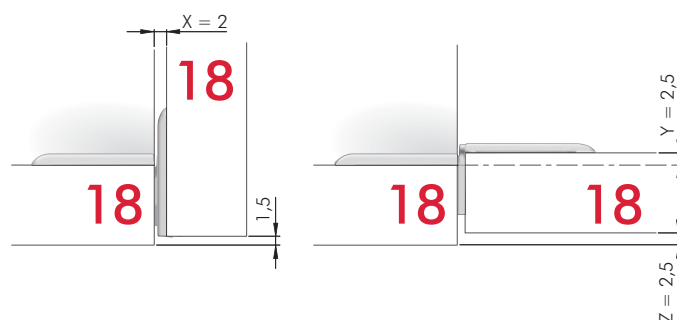
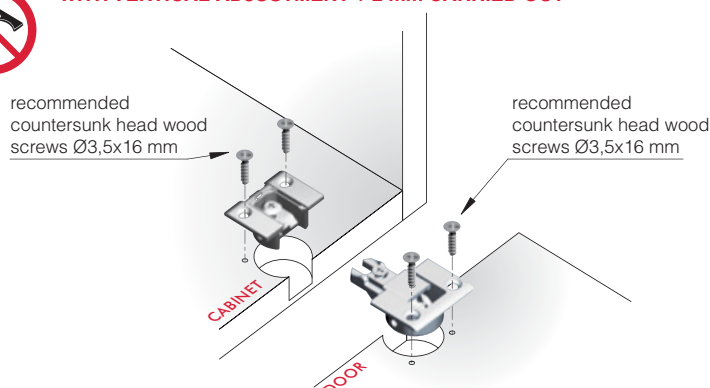
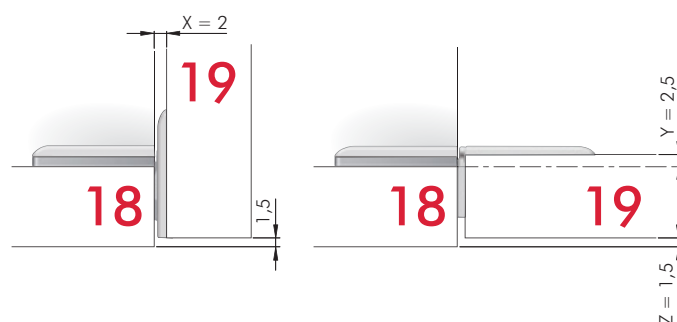
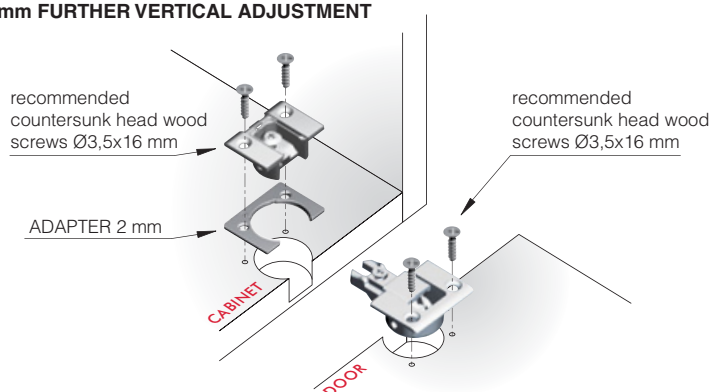
CABINET 18 mm WITHOUT ADAPTER - DOOR 18 mm WITHOUT ADAPTER

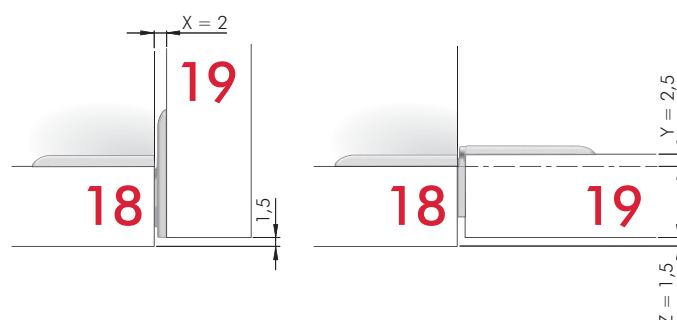
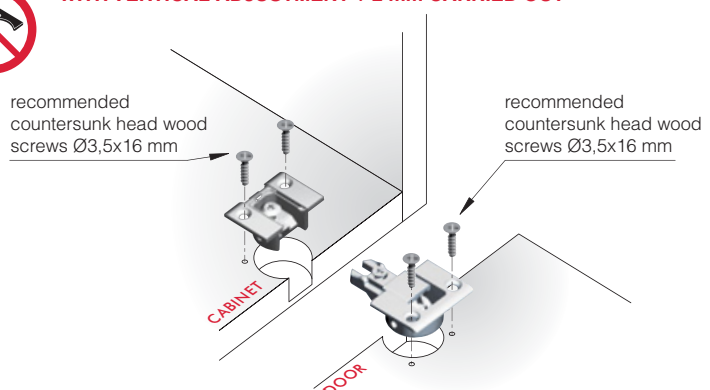
WITH VERTICAL ADJUSTMENT + 2 mm CARRIED OUT

CABINET 18 mm WITH ADAPTER 2 mm THICK - DOOR 19 mm WITHOUT ADAPTER
0 + 2 mm FURTHER VERTICAL ADJUSTMENT

CABINET 18 mm WITHOUT ADAPTER - DOOR 19 mm WITHOUT ADAPTER

WITH VERTICAL ADJUSTMENT + 2 mm CARRIED OUT

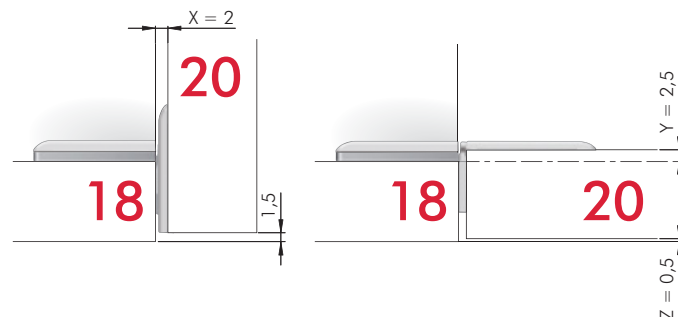
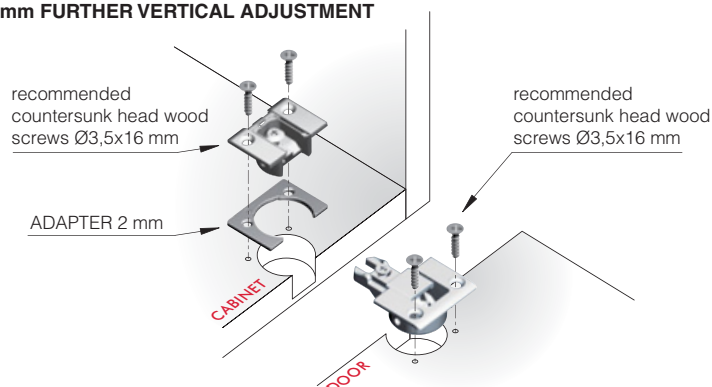

CABINET 18 mm WITH ADAPTER 2 mm THICK - DOOR 20 mm WITHOUT ADAPTER

0 + 2 mm FURTHER VERTICAL ADJUSTMENT



CABINET 18 mm WITHOUT ADAPTER - DOOR 20 mm WITHOUT ADAPTER



WITH VERTICAL ADJUSTMENT + 2 mm CARRIED OUT

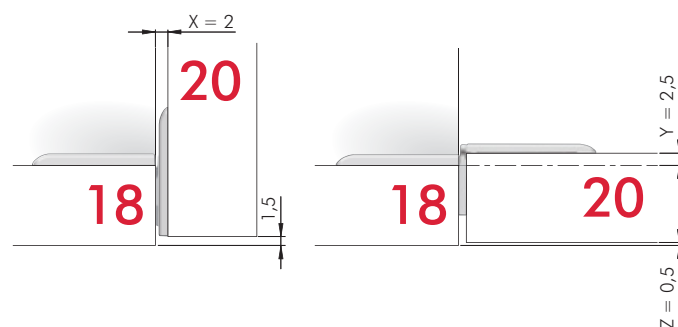
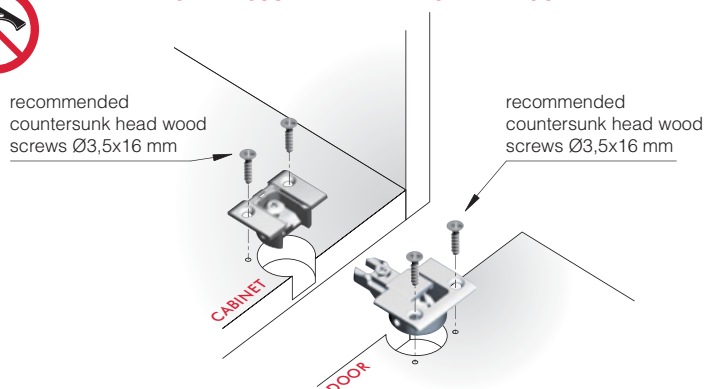

CABINET 19 mm WITHOUT ADAPTER - DOOR 16 mm WITH ADAPTER 2 mm THICK

0 + 2 mm FURTHER VERTICAL ADJUSTMENT

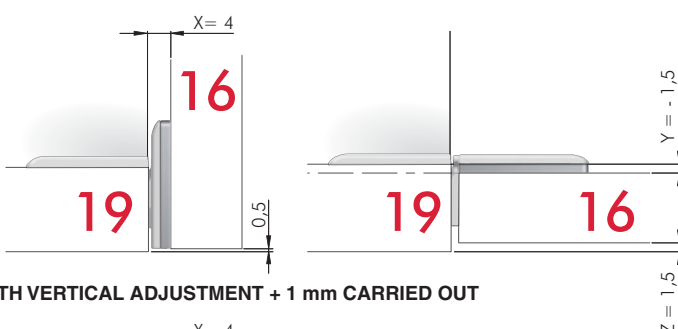
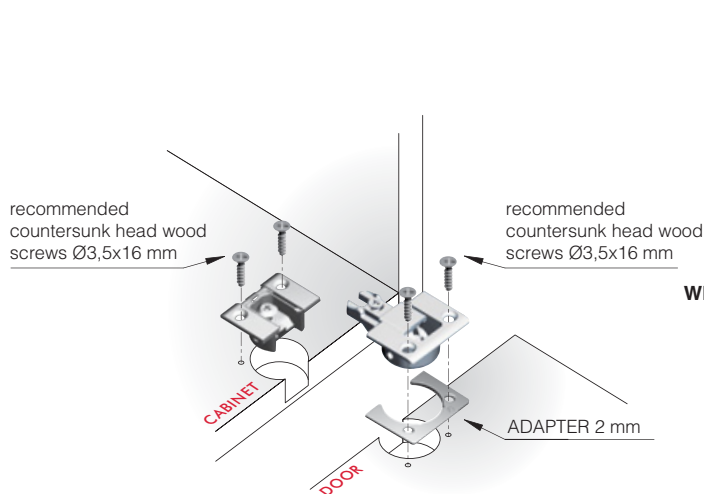

WITH VERTICAL ADJUSTMENT + 1 mm CARRIED OUT

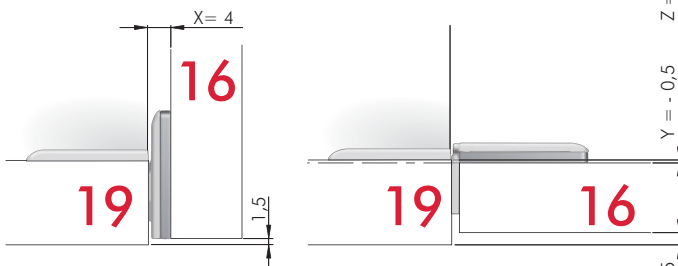

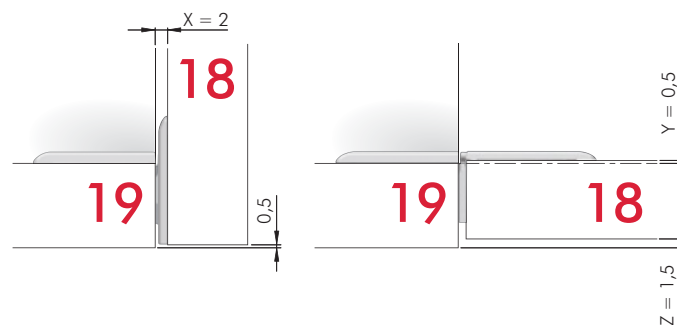
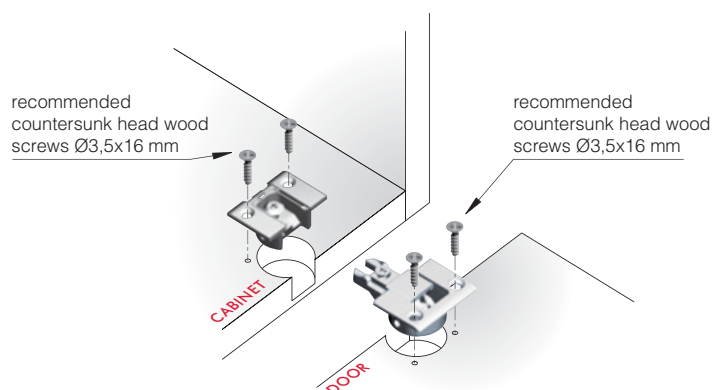
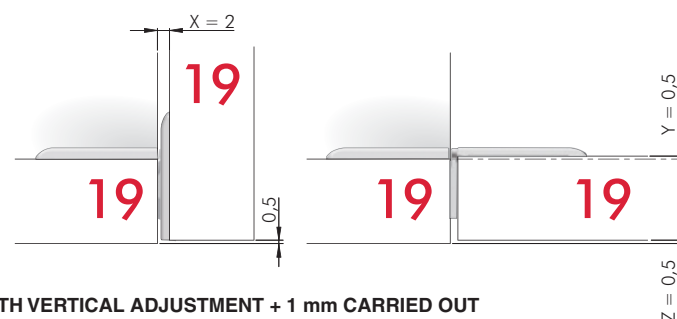
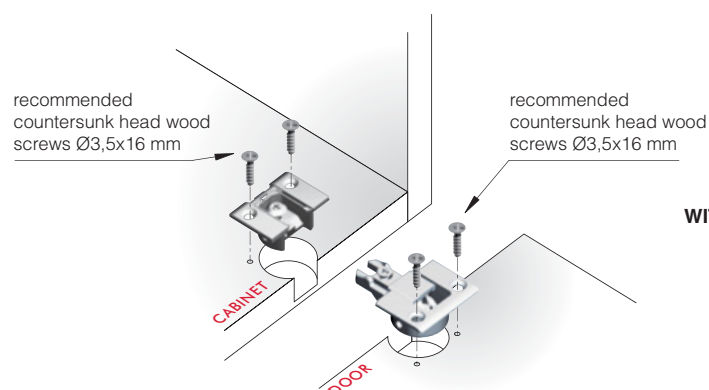
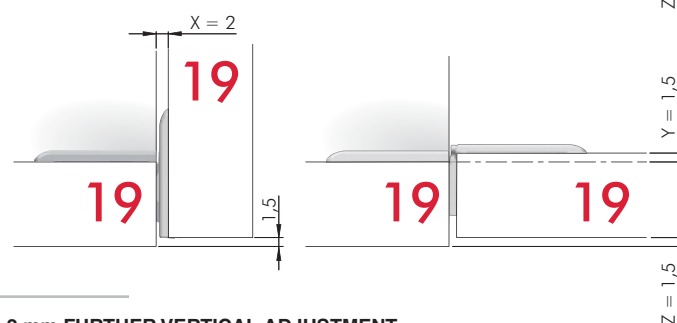
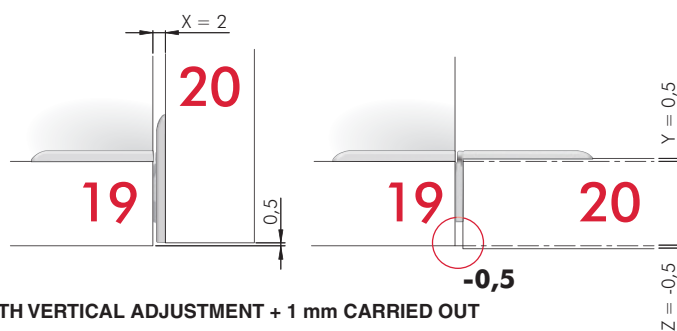
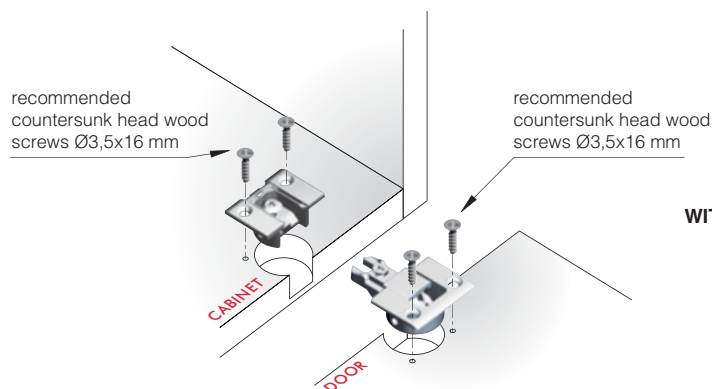
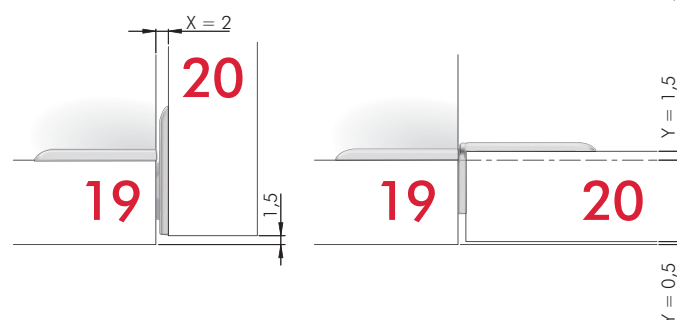
**CABINET 19 mm WITHOUT ADAPTER - DOOR 18 mm WITHOUT ADAPTER****CABINET 19 mm WITHOUT ADAPTER - DOOR 19 mm WITHOUT ADAPTER****0 + 2 mm FURTHER VERTICAL ADJUSTMENT****WITH VERTICAL ADJUSTMENT + 1 mm CARRIED OUT****CABINET 19 mm WITHOUT ADAPTER - DOOR 20 mm WITHOUT ADAPTER****0 + 2 mm FURTHER VERTICAL ADJUSTMENT****WITH VERTICAL ADJUSTMENT + 1 mm CARRIED OUT**



CABINET 20 mm WITHOUT ADAPTER - DOOR 18 mm WITHOUT ADAPTER

0 + 2 mm FURTHER VERTICAL ADJUSTMENT

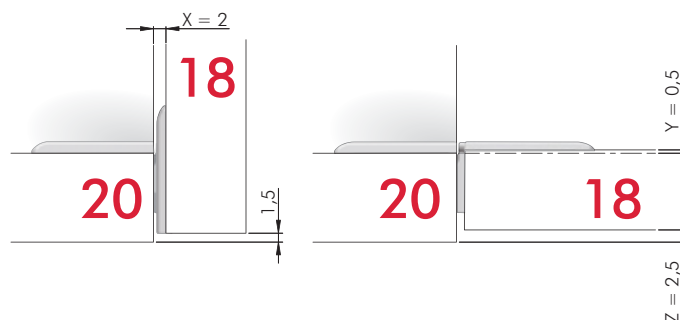
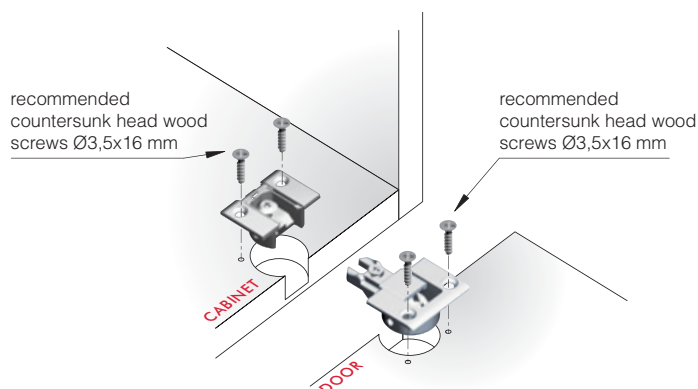

CABINET 20 mm WITHOUT ADAPTER - DOOR 19 mm WITHOUT ADAPTER

0 + 2 mm FURTHER VERTICAL ADJUSTMENT

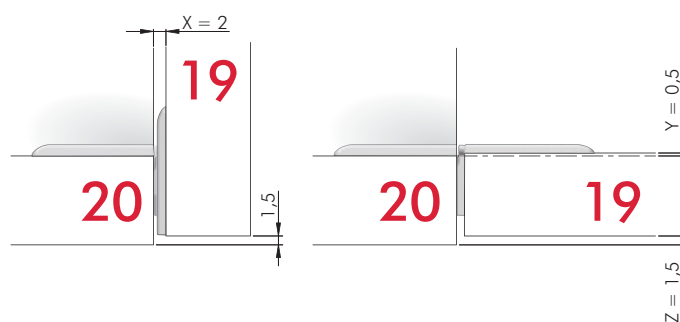
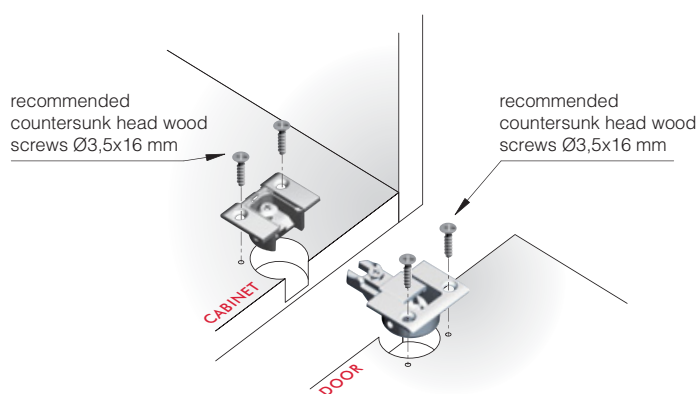

CABINET 20 mm WITHOUT ADAPTER - DOOR 20 mm WITHOUT ADAPTER

0 + 2 mm FURTHER VERTICAL ADJUSTMENT

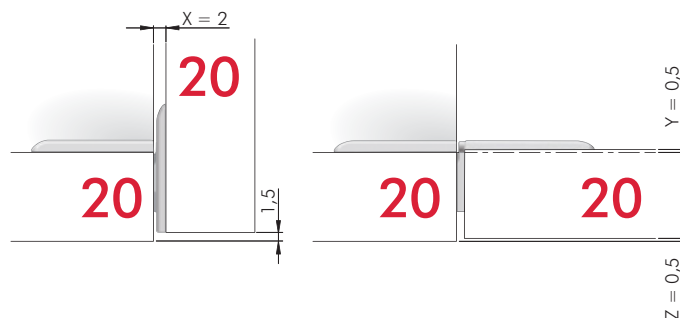
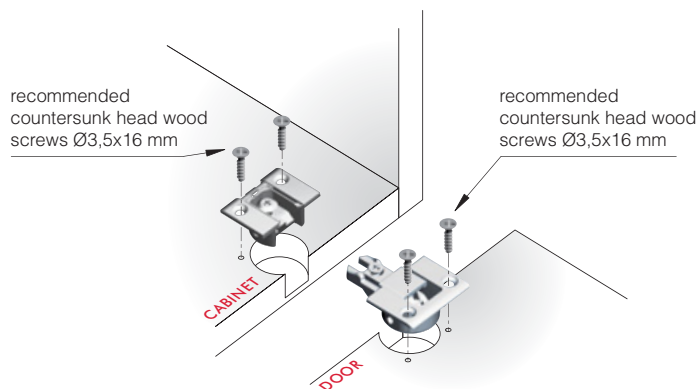

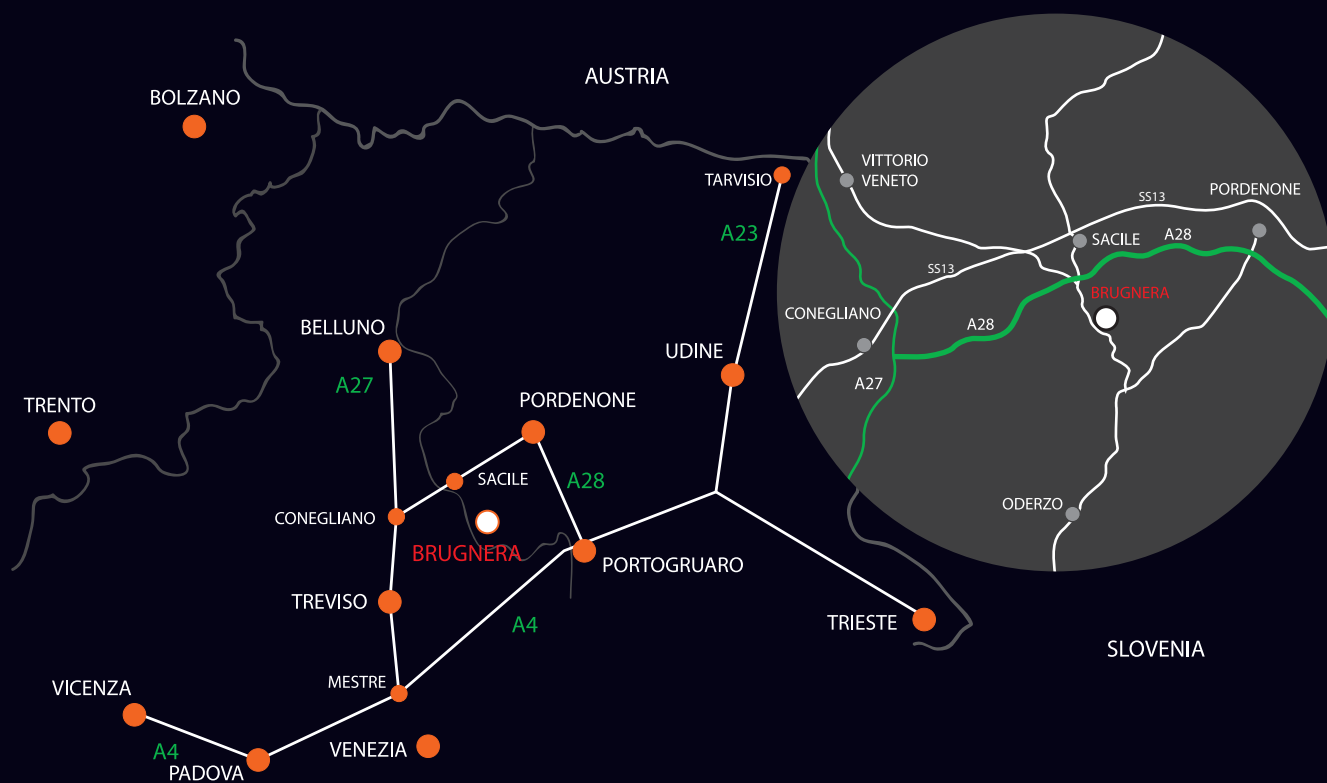

www.italianaferramenta.com