

**930+800** 121,9x21,7 mm

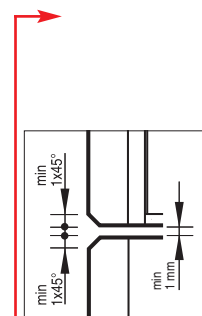

Patented

Cod.	Zinc alloy		
C1930800OTT00	brass	180°	20
C1930800NIK00	nickel	180°	20
C1930800NOP00	nickel chrome	180°	20
C1930800ARG00	silver painted	180°	20

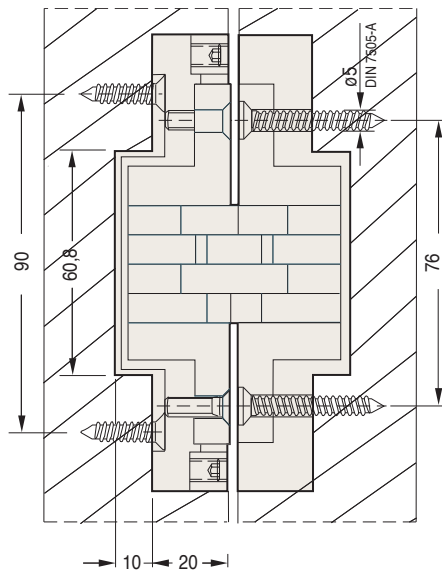
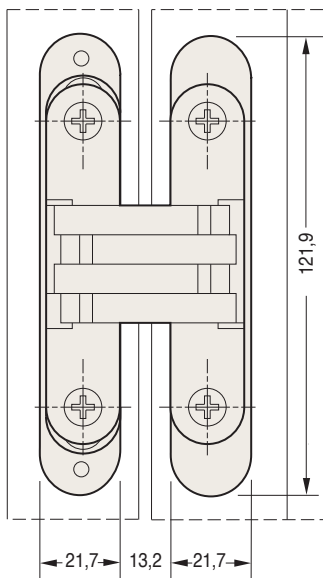

Mortise dimensions

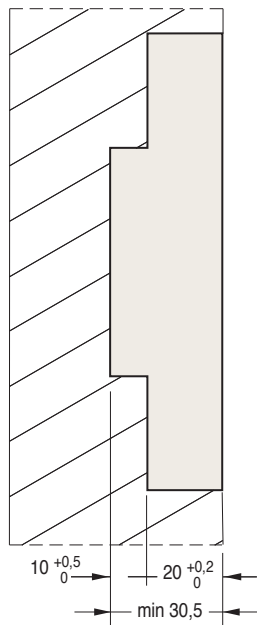
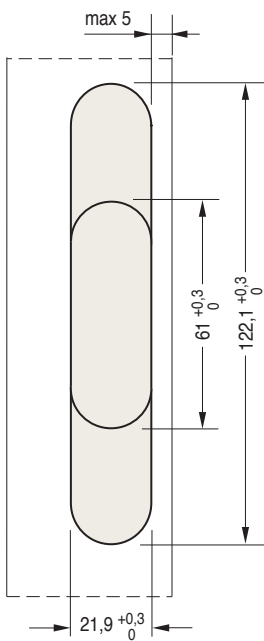

Cross section

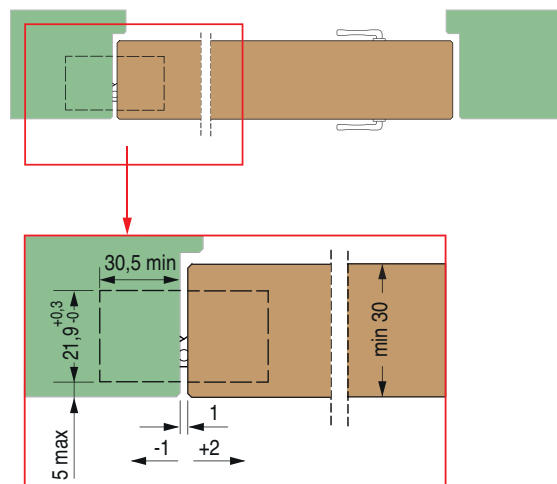

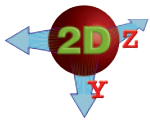

**930+800** 121,9x21,7 mm



Load capacity

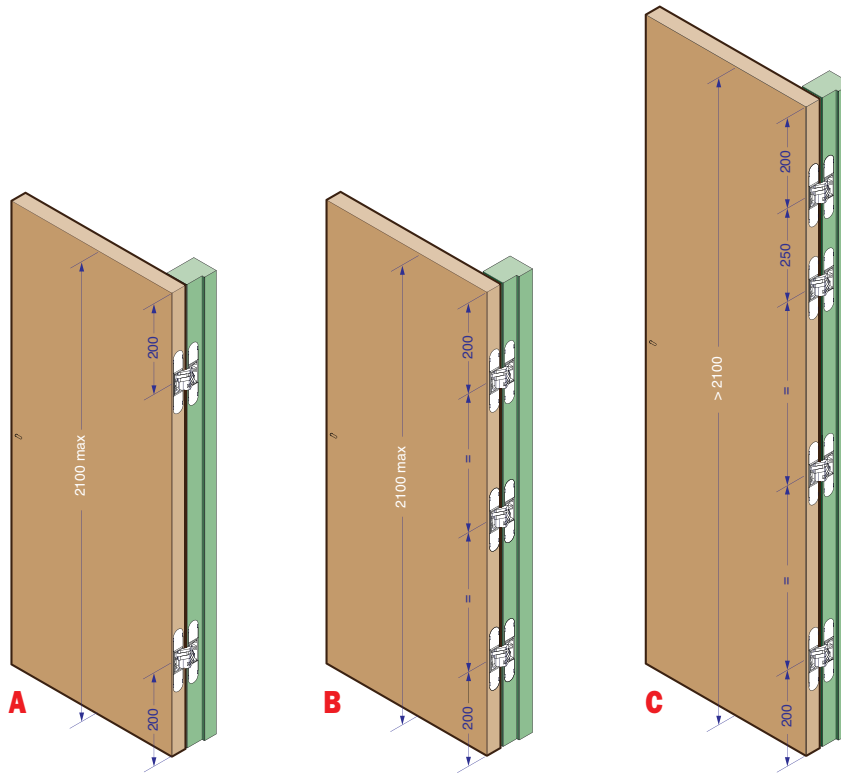

Wings  
850 mm wide

- up to 2100 mm high  
**A** - 2 hinges 40 kg  
**B** - 3 hinges 60 kg
- over 2100 mm high  
**C** - 4 hinges 60 kg

Before using a door closer, contact our technical office at ph. +39 031 771316

All hinges must be adjusted

Lubricate the hinges at least once a year

Installation

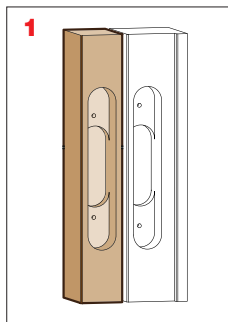

1  
Hollows execution in the door and in the post

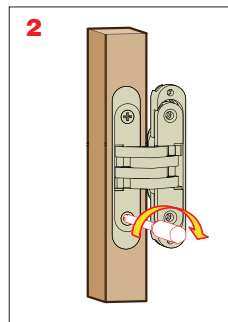

2  
Mounting of fixed base and of hinge in the door; flat countersunk-head self-tapping screw

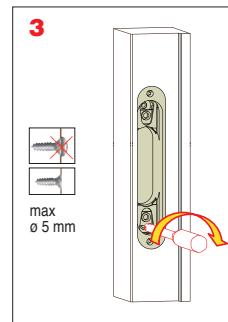

3  
Mounting of fixed base and of hinge in the door; flat countersunk-head self-tapping screw

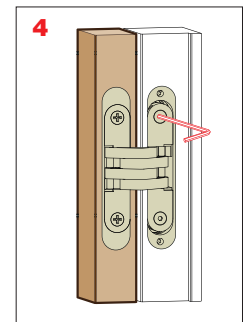

4  
Mounting of hinge in the post; countersunk-head screw, allen screw included in the kit

Adjusting

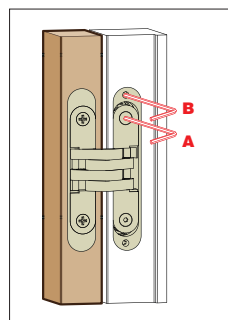

**Depth**

1 Loosen A  
2 Adjust B  
3 Tighten A

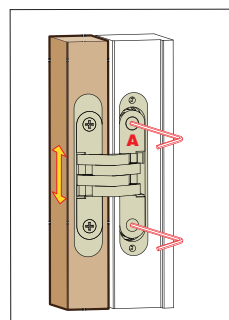

**Vertical**

1 Loosen A  
2 Adjust the door  
3 Tighten A